

The following catalog  
has gaps in its page  
numbers, or doesn't  
have any numbers.  
We have chosen to  
leave the page  
numbering in the  
order that Acrobat  
assigns it.

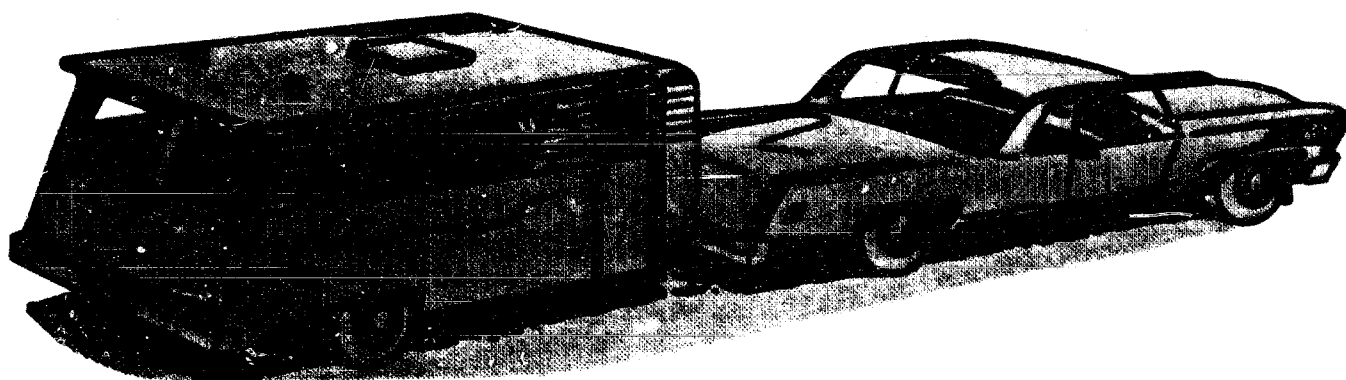

# **OPERATOR'S MANUAL AND PARTS CATALOG**

•



•

## **TL SERIES**

•

**Engine Driven, 12-Volt Battery Charge  
for  
Recreational Vehicles**

•

---

**ONAN**

**1400 73RD AVENUE N.E. • MINNEAPOLIS, MINNESOTA 55431**  
A DIVISION OF ONAN CORPORATION

# ENGINE, FUEL SYSTEM AND HOUSING GROUP

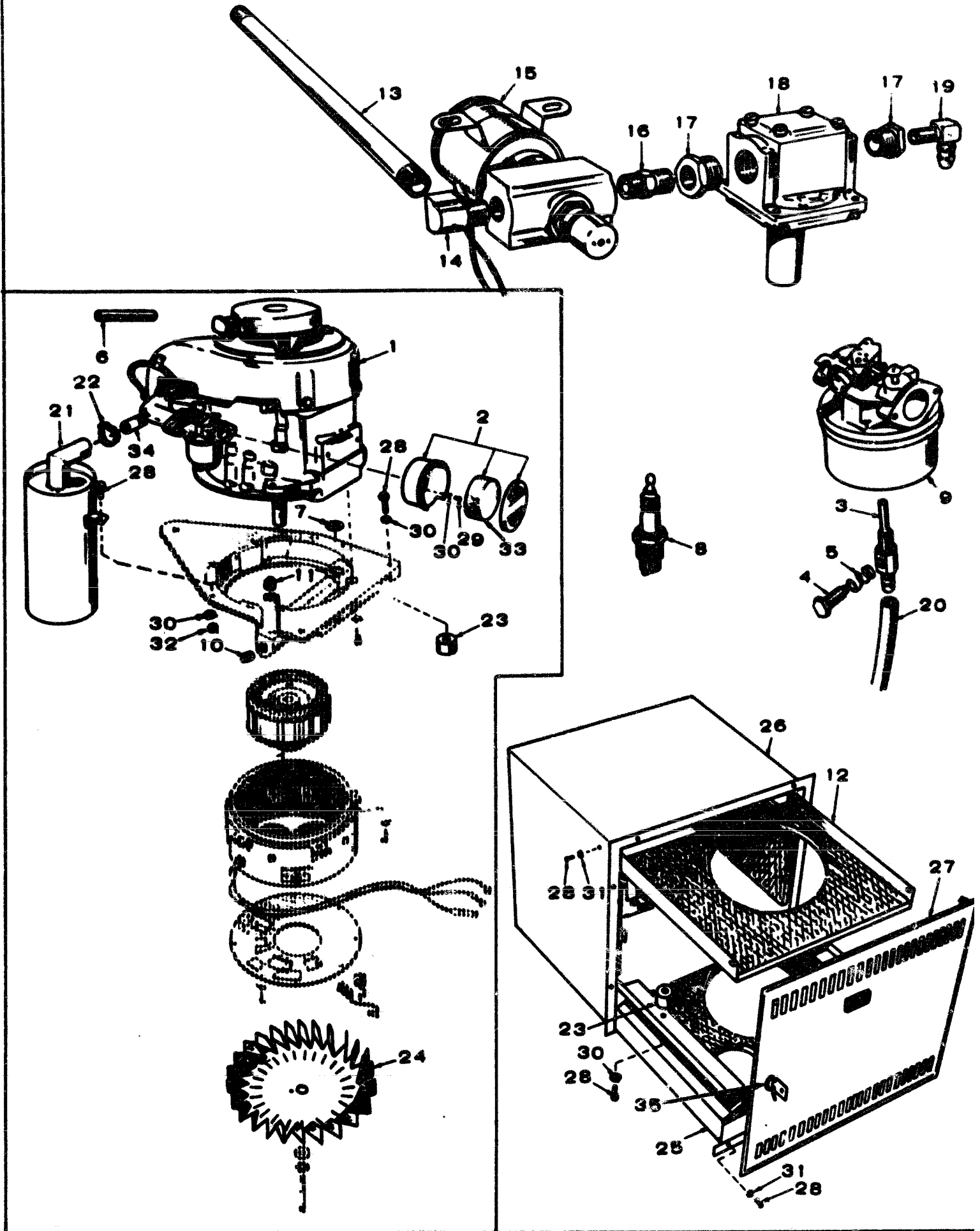

REF. NO.	PART NO.	QTY. USED	PART DESCRIPTION
1	100A1103	1	*Engine, Complete - Includes Parts Marked Δ
2	140A1147	1	ΔCleaner, Air (Complete)
3	148A707	1	† ΔAdapter, Gas
4	148A708	1	† ΔScrew, Carburetor
5	146A117	1	† ΔSpring, Power Needle
6	503A318	1	Spacer, Starter Rope
	508A169	1	Washer, Neoprene - Oil Line Adapter
8	167-238	1	ΔPlug, Spark
9	146A167	1	Carburetor - Includes Parts Marked †
10	505-54	1	Plug, Pipe - Oil Drain
11	505-110	1	Plug, Pipe - Oil Fill
12	405C1932	1	Baffle, Air Inlet (Incl. Insulation)
13	505-753	1	Nipple, Pipe (1/8 x 1/2")
14	502-20	1	Elbow, Street - Fuel Solenoid Inlet
15	307P1147	1	Solenoid, Fuel
16	502-82	1	Nipple, Hex - Fuel Solenoid Regulator
17	505-16	2	Bushing, Reducer - Regulator Inlet & Outlet
18	148-712	1	Regulator, Gas
19	502-313	1	Elbow, Regulator Outlet
20	503-449	1	Hose, Fuel
21	155C1185	1	Muffler, Exhaust
22	503A183	1	Clamp, Muffler
23	402A78	3	Mount, Vibration
24	13402314	1	Wheel, Blower
25	405C1917	1	Base (Includes Insulation)
26	405D1902	1	Housing (Includes Insulation)

REF. NO.	PART NO.	QTY. USED	PART DESCRIPTIONS
27	DOOR (INCLUDES INSULATION AND LOCK)		
	405B1929	1	Standard (Painted)
	405B1939	1	Optional (Stainless Steel)
28	SCREW, HEX CAP		
	800-45	3	Base Mounting
	800-5	1	Muffler Mounting
	800-2	4	Housing to Base
	800-2	5	Baffle & Housing
	800-45	3	Vibration Damper Mounting (5/16-18 x 5/8")
29	615-367	2	ΔScrew, Round Head - Air Cleaner Mounting
30	WASHER, LOCK		
	850-45	3	Base Mounting
	850-30	2	ΔAir Cleaner Mounting
	850-40	1	Muffler Mounting
	850-45	6	Vibration Damper Mounting
31	WASHER, SHAKEPROOF		
	853-13	4	Housing to Base
	853-13	5	Baffle to Housing
32	862-1	1	Nut, Hex - Muffler Mounting
33	140A1187	1	Element, Air Cleaner
34	505-185	1	ΔNipple, Element
35	406-345	1	Lock, Door

\* For engine components not listed, contact your nearest Tecumseh Products dealer, giving complete Model and Serial Number.

Δ Parts included in 100A1103 engine.

† Parts included in 146A167 carburetor.

**NOTE:** Tecumseh Products Company has established a short block number 750270 and a crankshaft number 31878 for this engine, to be purchased from your nearest Tecumseh dealer.

# GENERATOR AND CONTROL GROUP

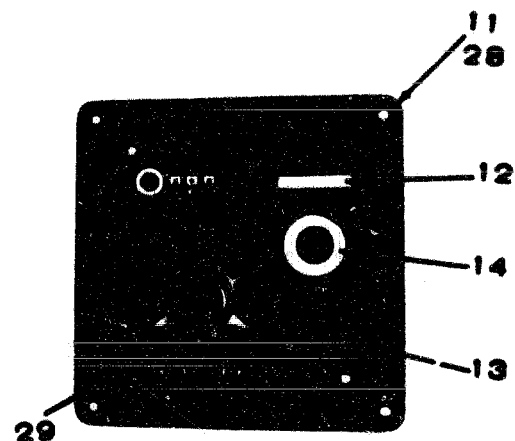
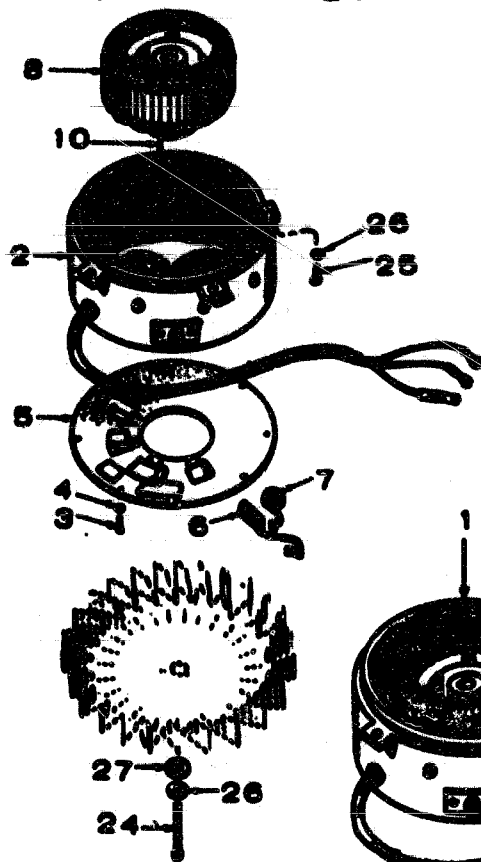
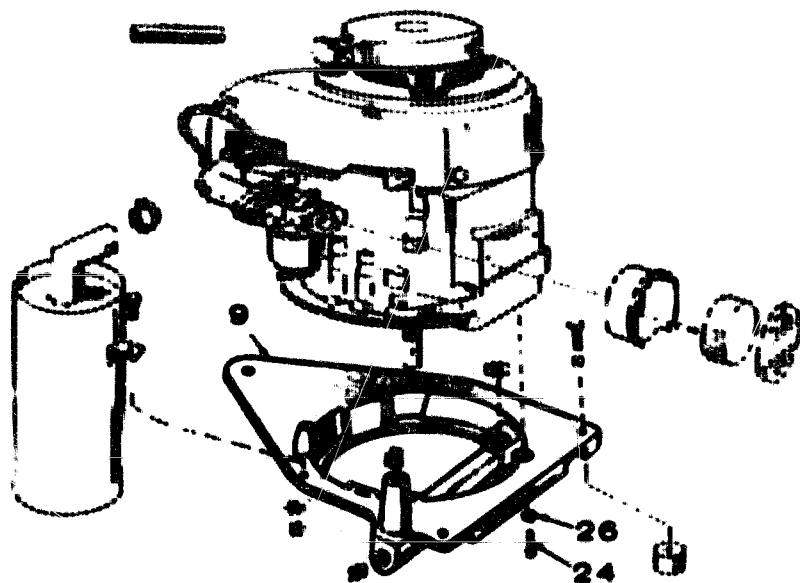
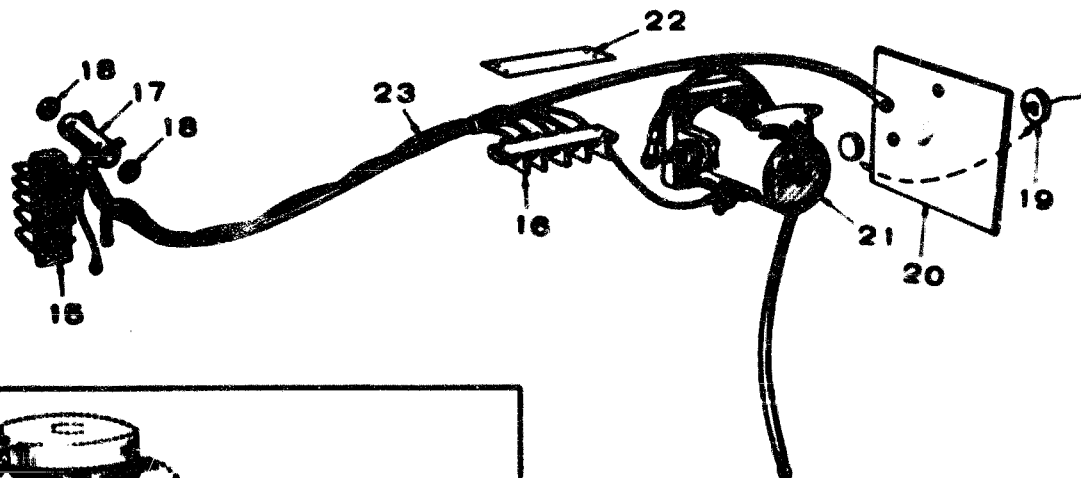

REF. NO.	PART NO.	QTY. USED	PART DESCRIPTION
1	249D14	1	Generator, Complete (Includes Parts Marked *)
2	249-15	1	*Frame Assembly (Includes Parts Marked ‡)
3	249-21	8	*1Screw, Pan Head
4	249-20	8	*1Washer, Lock
5	249-19	1	*1Plate Assembly, Yoke
6	249-17	4	*1Brush
7	249-18	4	*1Spring, Brush
8	249-16	1	*Armature Assembly
9	231E156	1	Adapter, Generator
10	516-185	1	Pin, Roll-Generator Drive
11	301A3007	1	**Panel, Control
12	322-116	1	**Light
13	308-312	1	**Switch, Running Time
14	313P34	1	**Switch, Start
15	332A537	1	†Block, Terminal (4 Place - Solder Terminals)
16	332A514	1	†Block, Terminal (4 Place - Screw Terminals)
17	304A168	1	†Resistor (1.5-Ohm, 25 Watt)
18	304A14	2	Washer, Resistor Centering

REF. NO.	PART NO.	QTY. USED	PART DESCRIPTIONS
19	358-25	1	Rectifier, Silicon
20	363-61	1	Sink, Heat
21	307B1046	1	Relay, Start Solenoid
22	332-1476	1	Strip, Marker
23	338D671	1	Harness, Wiring (includes Parts Marked †)
24	SCREW, HEX CAP		
	800-31	3	Generator Adapter to Engine
	800-59	1	Generator, Through
25	812-125	5	Screw, Round Head - Generator to Adapter
26	WASHER, LOCK		
	850-45	3	Generator Adapter to Engine
	850-35	5	Generator to Adapter
	850-50	1	Generator Through Screw
27	526A240	1	Washer, Flat - Generator Through Screw
28	300-936	1	Control Assembly - Includes Parts Marked **
29	KNOB, RUNNING TIME SWITCH		
	308P335	1	Black
	308P336	1	Ivory

\* Included in Complete Generator Number 249D14.

\*\* Included in Control Assembly 300-936.

‡ Included in Frame Assembly Number 249-15.

† Included in Wiring Harness Number 338D671.

# WIRING DIAGRAM

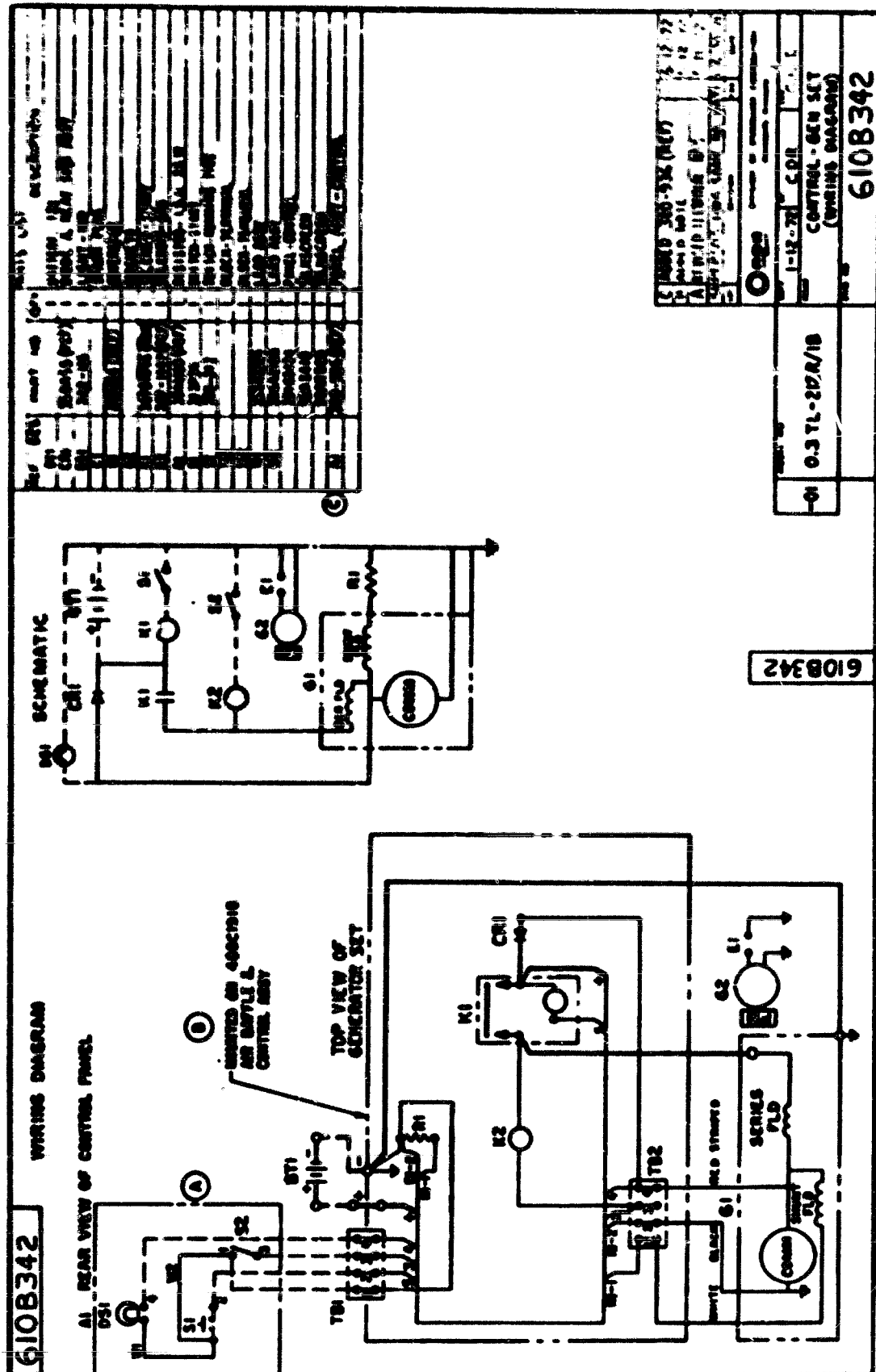

SPECIAL PARTS LIST FOR **MODEL** 0.3TL-212R **SPEC** 1B  
FOR STANDARD PARTS REFER TO **CATALOG** 919-0303 **KEY NO.** -  
(PARTS CATALOG ALSO CONTAINS COMPONENTS FOR MAJOR OPTIONAL FEATURES LISTED BELOW)  
**WIRING DIAGRAM NO.** (AC) 610-0349-01

PART NO.	QTY.	DESCRIPTION	PART NO.	QTY.	DESCRIPTION
321-0196	1	Holder Assembly, Fuse (Includes Fuse)			
321-0195	1	Fuse, 3 Amp			



SPECIAL PARTS LIST FOR **MODEL** 0.3TL-212R **SPEC** 11810B  
 FOR STANDARD PARTS REFER TO **CATALOG** 919-0303 **KEY NO.** -  
 (PARTS CATALOG ALSO CONTAINS COMPONENTS FOR MAJOR OPTIONAL FEATURES LISTED BELOW)  
**WIRING DIAGRAM NO.** (AC) 610-0349-01

PART NO.	QTY.	DESCRIPTION	PART NO.	QTY.	DESCRIPTION
Manufactured For: Airstream					
321-0196	1	Holder Assembly, Fuse (Includes Fuse)			
321-0195	1	Fuse, 3 Amp			