

The following catalog
has gaps in its page
numbers, or doesn't
have any numbers.
We have chosen to
leave the page
numbering in the
order that Acrobat
assigns it.



Parts Catalog

DP Series

DR Series

DZ Series

125 - 350 kW

PMG GENERATOR SET



**Power
Generation**

A E B

Printed in U S A

Redistribution or publication of this document
by any means, is strictly prohibited.

General Information

For part or service, contact the distributor from whom you purchased this equipment or refer to the nearest Authorized Cummins Distributor.

To avoid errors or delays in filling your parts order, always give the full MODEL, SERIAL and ID No. from the nameplate.

For handy reference, insert "YOUR" nameplate information in the spaces below.

		AC Generator Set	
Model _____			
kw	kva	pf	phase
voltage		amps	
duty		overload	
rpm		hs	
class of insulation		pmg voltage	
field amp max		field voltage max	
generator model no.			
voltage regulator model no.			
ID no.			
generator set serial no.			
BS5000		NEMA	



**Power
Generation**

Redistribution or publication of this document by any means, is strictly prohibited.

TABLE OF CONTENTS

	GRID
INTRODUCTION	A4
INDEX	A5
EXTERNAL ENGINE COMPONENTS - RIGHT SIDE	A7
EXTERNAL ENGINE COMPONENTS - LEFT SIDE	A9
COOLING SYSTEM - RADIATOR 125 - 300 KW SETS	A11
COOLING SYSTEM - RADIATOR 310-350 KW SETS	A13
ENGINE COOLANT HEATER (INSTALLED AT ENGINE FACTORY)	A15
ENGINE COOLANT HEATER (INSTALLED AT GENERATOR ASSEMBLY)	A17
BLANK PAGE	A18
TABLE OF CONTENTS FOR GENERATOR SECTION	B8
GENERATOR (125, 145, 150, 175 KW SETS ONLY)	B9
GENERATOR (190-350KW SETS ONLY)	B10
STATOR SECTION OF GENERATOR (125, 145, 150, 175KW SET)	B12
STATOR SECTION OF GENERATOR (190-300 & 350KW SETS)	B14
STATOR SECTION OF GENERATOR (310KW SET ONLY)	B16
GEN ROTOR SECTION (125, 145, 150, 175KW SETS)	B18
GEN ROTOR SECTION (190-300 & 350KW SETS)	B20
GEN ROTOR SECTION (310KW SET ONLY)	B22
BLANK PAGE	B23
PERMANENT MAGNET EXCITER	B24
OVERSPEED SENSOR	B25
OVERSPEED SWITCH	C1
BLANK PAGE	C2
TABLE OF CONTENTS FOR GENERATOR SET CONTROLS	C3
GENERATOR SET CONTROL (WITH HOUSING ENCLOSURE)	C5
ENGINE CONTROL COMPONENTS (SETS WITH HOUSING ENCLOSURE)	C7
GENERATOR CONTROL COMPONENTS (SETS WITH HOUSING ENCLOSURE)	C9
CONTROL HEATER (SETS WITH HOUSING ENCLOSURE)	C10
POTENTIAL TRANSFORMER (SETS WITH HOUSING ENCLOSURE)	C11
BLANK PAGE	C12
WATTMETER (SETS WITH HOUSING ENCLOSURE)	C13
GENERATOR SET CONTROL (WITHOUT HOUSING ENCLOSURE)	C15
ENGINE CONTROL COMPONENTS (SETS WITHOUT HOUSING ENCLOSURE)	C17
GENERATOR CONTROL COMPONENTS (SETS WITHOUT HOUSING ENCLOSURE)	C19

Introduction

This Parts Manual applies to the Standard Gen Sets Listed below. The illustrations are arranged in groups of related items, and each part or assembly is identified by a Reference Number. All parts illustrated are typical, and unless otherwise mentioned the description column the parts are interchangeable between models.

These typical illustrations are subject to change and reflect only the latest replacement parts arrangement. The Right and Left sides of the Set are determined by FACING the FRONT (Engine end) of the Set.

Set Data Table

MODEL IDENTIFICATION	RATING	RPM RATING*	BATTERY VOLTAGE
125.0D BB - */ # @	125,000 WATTS	1500 RPM	24 VDC
145.0D BB - */ # @	145,000 WATTS	1500 RPM	24 VDC
150.0D BB - */ # @	150,000 WATTS	1800 RPM	24 VDC
165.0D BB - */ # @	165,000 WATTS	1500 RPM	24 VDC
175.0D BB - */ # @	175,000 WATTS	1800 RPM	24 VDC
190.0D BB - */ # @	190,000 WATTS	1500 RPM	24 VDC
200.0D BB - */ # @	200,000 WATTS	1800 RPM	24 VDC
220.0D BC - */ # @	220,000 WATTS	1500 RPM	24 VDC
230.0D BB - */ # @	230,000 WATTS	1800 RPM	24 VDC
250.0D BC - */ # @	250,000 WATTS	1800 RPM	24 VDC
275.0D CB - */ # @	275,000 WATTS	1500 RPM	24 VDC
300.0D CB - */ # @	300,000 WATTS	1800 RPM	24 VDC
310.0D DB - */ # @	310,000 WATTS	1500 RPM	24 VDC
350.0D DB - */ # @	350,000 WATTS	1800 RPM	24 VDC

* - Voltage Codes follow Model Letter designations.

- Specification Number: Number 1 is Standard, all others indicate variations.

@ - Specification Letter: Letter advances (A to B, B to C, etc) with major manufacturing changes.

Electrical Data Table

*VOLTAGE CODE	VOLTS	HERTZ	WIRE	PHASE	NOTES
H	347/600	60	4	3	
L	120/208	60	12	3	
	127/220	60	12	3	
	139/240	60	12	3	
	240/416	60	12	3	
	254/440	60	12	3	
	277/480	60	12	3	
Z	110/190	50	12	3	
	115/200	50	12	3	
	120/208	50	12	3	
	127/220	50	12	3	
	220/380	50	12	3	
	230/400	50	12	3	
	240/416	50	12	3	
	254/440	50	12	3	

* - The Stators are Reconnectible.

Engine Replacement Parts

The External Engine Components added or modified during the Generator Set Assembly have been identified in this Parts Manual. For Internal Engine Parts and other parts not covered herein, refer to the applicable engine manufacturer's literature. Reproduction of this document by any means, is strictly prohibited.



Index

	GRID		GRID
Adapter, Generator	B18, B20, B22	Light, Indicator	C7, C17
Ammeter - AC	C9, C19	Line, Fuel - Flex	A7
Ammeter - DC	C7, C17		
Bracket, End - Generator	B12, B14, B16	Meter, Frequency	C9, C15
Cable, Battery	A9	Meter, Tach	C7, C17
Cap, Radiator	A11, A13	Meter, Time - Running	C9, C15
Control, Engine	C7, C17	Radiator	A11, A13
Control, Generator	C9, C19	Rotor, Exciter	B18, B20, B22
Control, Generator Set	C5, C15	Sender, Pressure - Oil	A7
Cooling System	A11, A13	Sender, Temperature - Low Engine	A7
Disk, Drive - Generator	B18, B20, B22	Sender, Temperature - Oil	A7
Drain, Oil	A9	Sender, Temperature - Water	A7
Gasket, Drain - Oil	A9	Stator, Exciter	B12, B14, B16
Gauge, Pressure - Oil	C7, C17	Switch, Level - Coolant	A11, A13
Gauge, Temperature - Oil	C7, C17	Switch, Overspeed	B25
Gauge, Temperature - Water	C7, C17	Switch, Pressure - Low Oil	A7
Generator	B9, B10	Switch, Push - Reset/Panel	C7, C17
Guard, Fan	A11, A13	Switch, Push - Run/Stop/Remote	C7, C17
Harness, Wiring - Control (AC)	C9, C19	Switch, Rotary - Generator Control	C9, C15
Harness, Wiring - Control (DC)	C7, C17	Switch, Temperature - Hi Water	A7
Harness, Wiring - Control To Engine	C7, C15	Switch, Temperature - Pre Water	A7
Harness, Wiring - Control to Generator	C15		
Harness, Wiring - Control to Governor	C17	Transformer, Current	C5, C15
Harness, Wiring - Meter to Eng Monitor	C17	Transformer, Potential	C17
Harness, Wiring - Speed Control to Jack	C17	Valve, Drain - Oil	A9
Harness, Wiring - Fuse Block to Jack	C19	Voltmeter	C7, C9, C17, C15
Heater, Control	C10		
Hose, Drain - Oil	A9	Wattmeter	C15
Hose, Radiator	A11, A13		
Housing, Control	C5		

External Engine Components Right Side

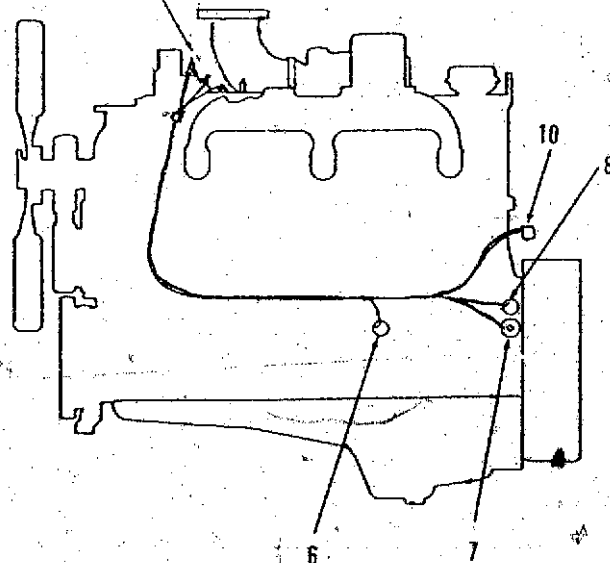
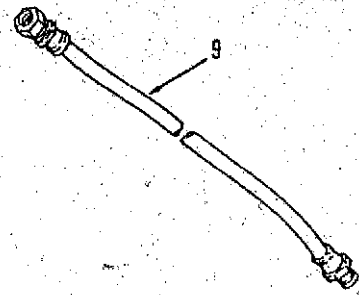
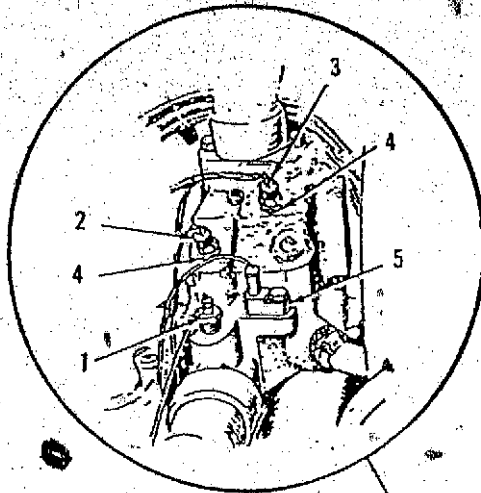

External Engine Components Right Side

REF NO.	PART NO.	QTY USED	PART DESCRIPTION	REF NO.	PART NO.	QTY USED	PART DESCRIPTION
1	193-0376	1	Sender, Temperature - Engine Coolant (E2)	10			Harness, Wiring - Engine to Control
2	309-0436	1	Switch, Thermostatic - Coolant Temperature - Alarm (S6)	338-2067	1		Sets with Control Housing Enclosure (Includes Connectors)
3	309-0437	1	Switch, Thermostatic - Coolant Temperature - Shutdown (S2)	323-1304	1		Housing, Connector - 6 PI
4	505-0117	1	Gushing, Reducer - Flush	323-1200	6		Contact, Pin
5	309-0269	1	Switch, Temperature - Low Engine Temperature (S4)	323-1306	1		Housing, Connector - 8 PI
6	309-0272	1	Switch, Pressure - Oil - Alarm (S5)	323-1200	8		Contact, Pin
7	193-0244	1	Sender, Pressure - Oil (E1)	338-2190-01	1		Sets without Control Housin- Enclosure (Includes a Connector housing)
8	309-0169	1	Switch, Pressure - Oil - Shutdown (S1)	323-1206	1		Housing, Connector (J11)
9			Line, Fuel - 50"Lg.	323-1194	20		Contact, Pin
	501-0519	1	3/4-14 Male X 3/4-16 Female				
	501-0520	1	3/4-14 Male X 7/8-14 Female				

External Engine Components Left Side

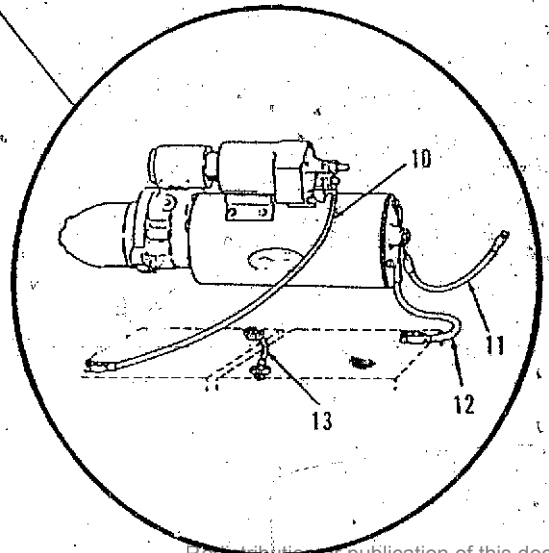
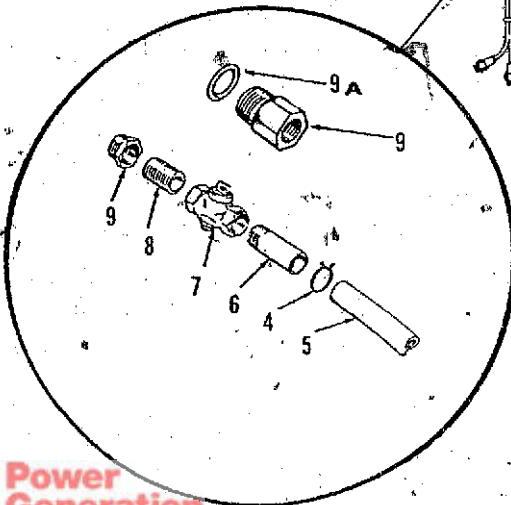
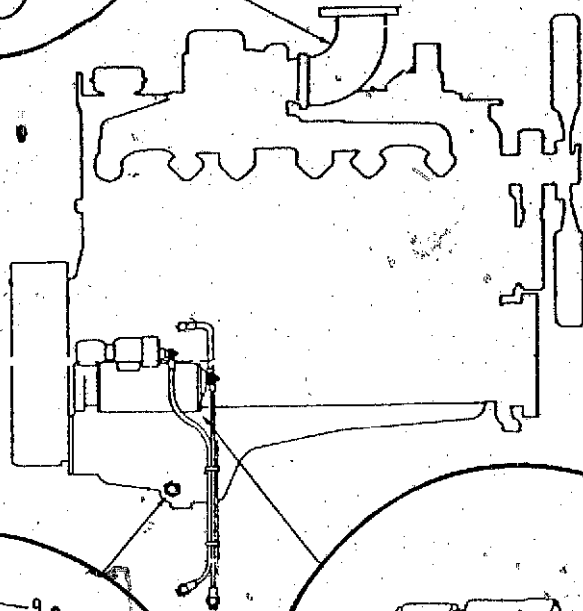
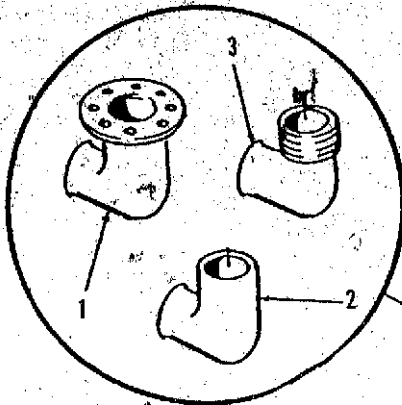

External Engine Components Left Side

REF NO.	PART NO.	QTY USED	PART DESCRIPTION	REF NO.	PART NO.	QTY USED	PART DESCRIPTION
1	155-2281	1	Elbow, Exhaust - Flanged	9			Bushing, Reducer - Hex (Select As Required)
	155-2310-01	1	125-300kW Sets		505-0022	1	1"NPT X 1/2"NPT
2			310-350kW Sets		102-1335	1	1-18NS-2 X 1/2"NPT
	155-1241	1	Elbow, Exhaust - Plain	9A	508-0292	1	Washer, Flat - Copper (Use with 102-1335)
	155-2310-02	1	125-300kW Sets				
3			310-350kW Sets	10	416-0636	1	Cable, Battery - Positive
	155-1036	1	Elbow, Exhaust - Threaded	11	416-0632	1	Cable, Electrical - Ground
	155-1970	1	125-300kW Sets				Attaching Parts
4	503-0197	1	310-350kW Sets		800-0049	1	Screw, Cap - Hex Head, (1/2-13 x 1-1/2")
5	503-0888	1	Clamp, Loop				
6	505-0185	1	Hose		850-0060	1	Washer, Lock - Spring (1/2")
7	504-0011	1	Nipple, Pipe - Half		856-0013	1	Washer, Lock - EIT (1/2")
8	505-0100	1	Valve	12	416-0639	1	Cable, Battery - Negative
			Nipple, Pipe - Close	13	416-0473	1	Cable, Electrical - Jumper



**Power
Generation**

Cooling System - Radiator 125 - 300 kW Sets

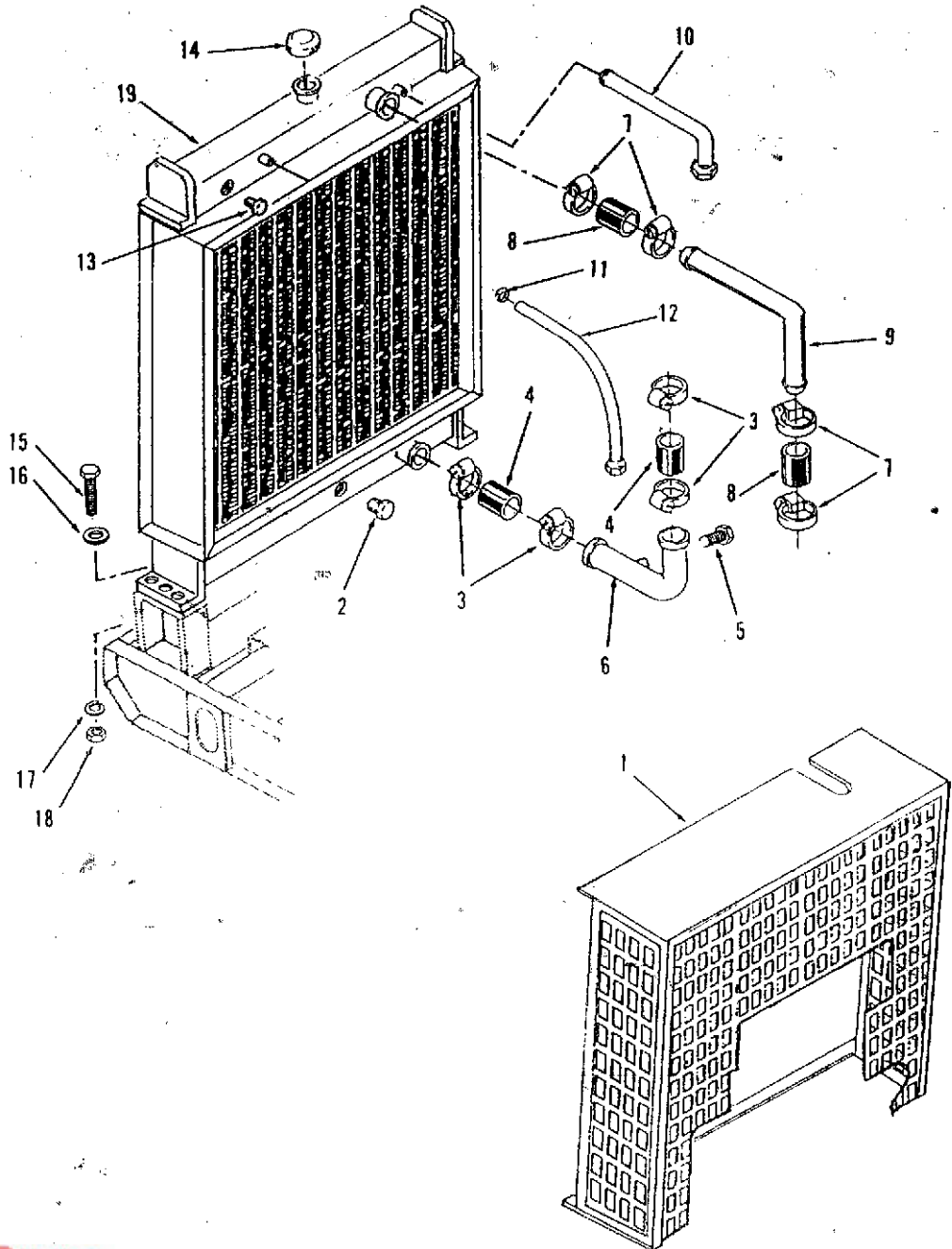

Cooling System - Radiator **125 - 300 kW Sets**

REF NO.	PART NO.	QTY USED	PART DESCRIPTION	REF NO.	PART NO.	QTY USED	PART DESCRIPTION
1	*	1	Guard, Fan	11	*	1	Clamp, Hose
2	*	1	Plug, Pipe (1/2"BSPT)	12	*	1	Tube, Vent
3	*	4	Clamp, Hose	13	502-0153	1	Plug, Pipe (1/4-18 NPTF)
4	*	2	Hose	14	*	1	Cap, Radiator - 10 LB
5	*	1	Plug	15	800-0030	6	Screw, Cap - Hex Head (5/16-18 x 1-1/4")
6	*	1	Pipe, Lower	16	526-0022	6	Washer, Flat (5/16)
7	*	4	Clamp, Hose	17	850-0045	6	Washer, Lock - Spring (5/16)
8	*	2	Hose	18	862-0015	6	Nut, Hex (5/16-18)
9	*	1	Pipe, Upper	19	*	6	Radiator
10	*	1	Pipe, Fill				

* - Part Number not available at time of Printing.

Cooling System - Radiator 310 - 350 kW Sets

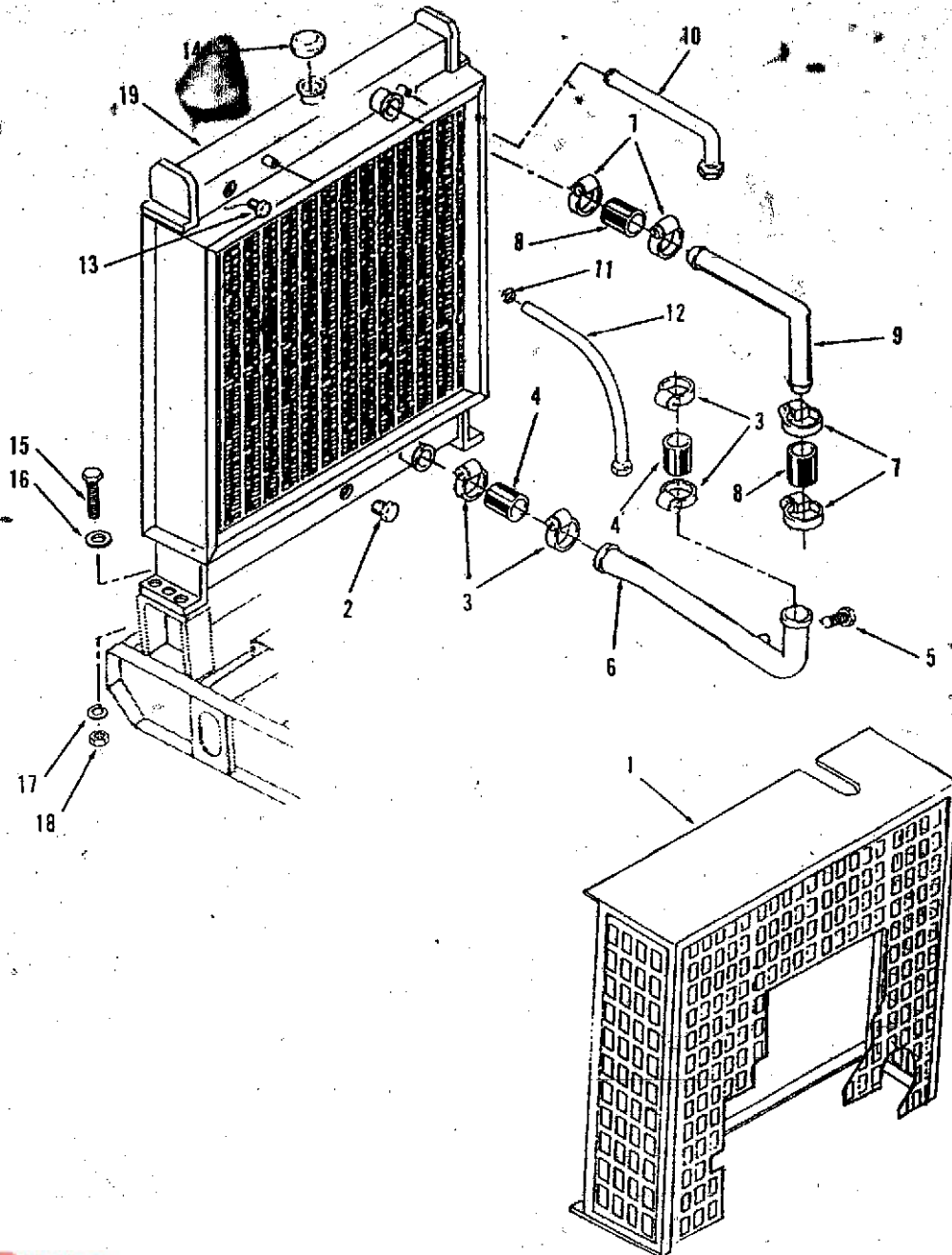

Cooling System - Radiator 310 - 350 kW Sets

REF NO.	PART NO.	QTY USED	PART DESCRIPTION
1	*	1	Guard, Fan
2	*	1	Plug, Pipe (1/2" BSPT)
3	*	4	Clamp, Hose
4	*	2	Hose
5	*	1	Plug
6	*	1	Pipe, Lower
7	*	4	Clamp, Hose
8	*	2	Hose
9	*	1	Pipe, Upper
10	*	1	Pipe, Fill

REF NO.	PART NO.	QTY USED	PART DESCRIPTION
11	*	1	Clamp, Hose
12	*	1	Tube, Vent
13	502-0153	1	Plug, Pipe (1/4-18 NPTF)
14	*	1	Cap, Radiator - 10 LB
15	800-0030	6	Screw, Cap - Hex Head (5/16-18 x 1-1/4")
16	526-0022	6	Washer, Flat (5/16)
17	850-0045	6	Washer, Lock - Spring (5/16)
18	862-0015	6	Nut, Hex (5/16-18)
19	*	1	Radiator

* - Part number not available at time of printing.



**Power
Generation**

Redistribution or publication of this document
by any means, is strictly prohibited.

Engine Coolant Heater (Installed at Engine Assembly Factory)

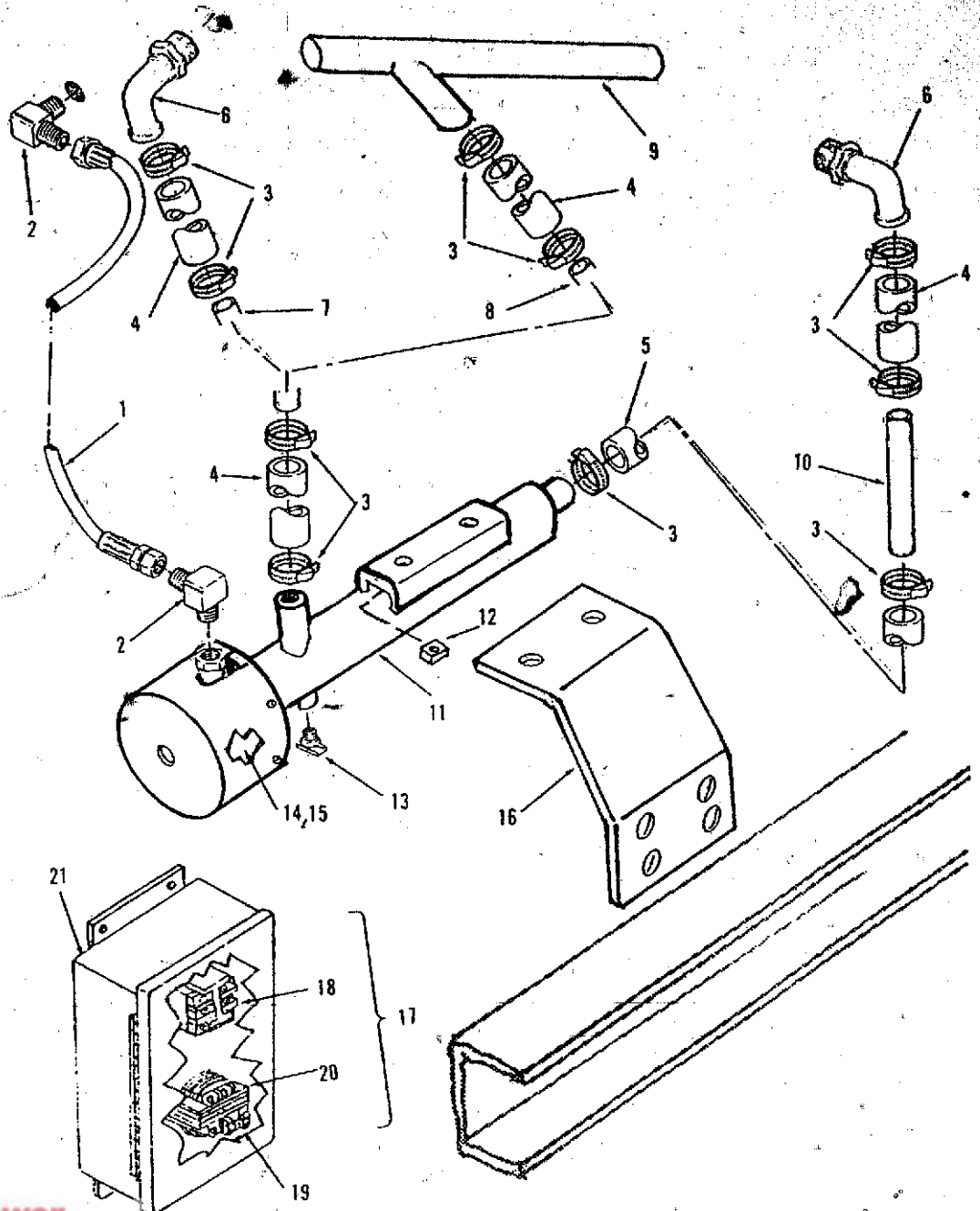

Engine Coolant Heater **(Installed at Engine Assembly Factory)**

REF NO.	PART NO.	QTY USED	PART DESCRIPTION	REF NO.	PART NO.	QTY USED	PART DESCRIPTION
1	501-0537-03	1	Hose Assembly - Oil Pressure	16	130-3189	1	Bracket, Mounting - Heater
2	502-1043-01	2	Elbow, Pipe - Male, 90 DEG				Attaching Parts for Bracket
3	503-1603	8	Clamp, Hose		800-0210	4	Screw, Cap - Hex Head (3/8-16 x 1-1/4")
4	503-1602	3	Hose, Rubber		850-0103	4	Washer, lock - Spring (3/8")
5	503-1604	1	Elbow, Hose - Rubber				Nut, Hex - Brass (3/8-16)
6	502-1047-01	1	Coupling, Hose - Elbow, 90 DEG		871-0028	4	Switch, Control - Heater (Includes Contactor, Step-down Transformer with Fuse[480V Unit Only], Ground Lug and Box)
	502-1047-01	2	Sets with Y Water Tube	17			120 VAC
7	130-3225	1	Sets without Y Water Tube		309-0567-01	1	480 VAC
8	130-3227	1	Tube, Water - 23"LG (Used on Set without Y Water Tube)		309-0567-02	1	Attaching Parts for Switch
9	130-3222	1	Tube, Water - 21"LG (Used on Set with Y Water Tube)		800-0222	4	Screw, Cap - Hex Head (1/4-20 x 3/4")
10	130-3225	1	Tube, Water - "Y"		850-0101	4	Washer, lock - Spring (1/4")
11			Heater, Electrical - Engine Coolant (Includes Thermostat, Oil Pressure Switch, Drain Cock and Mounting Nuts)		862-0031	4	Nut, Hex (1/4-20)
	333-0389-01	1	2500 Watt, 240 VAC	18		1	Contactor (37.5 AMP, 3 Pole, SPST, 120 VAC Coil)
	333-0389-02	1	4000 Watt, 240 VAC				Fuse (1 AMP)
	333-0389-03	1	2500 Watt, 120 VAC	19		1	Transformer, Step-down (240/480VAC Primary, 120 VAC Secondary, with Fuse Clips on output Terminals)
	333-0389-04	1	4000 Watt, 480 VAC (Includes Heater Control Switch Unit)	20			Box, Electrical
	333-0389-05	1	2500 Watt, 480 VAC (Includes Heater Control Switch Unit)		333-0390	1	Bracket, Mounting - Switch (Not Illustrated)
	333-0389-06	1	4000 Watt, 120 VAC (Includes Heater Control Switch Unit)				Attaching Parts for Bracket
			Attaching Parts for Heater	21		1	Screw, Cap - Hex Head (3/8-16 x 1-1/4")
	800-0222	2	Screw, Cap - Hex Head (1/4-20 x 3/4")	22		2	Washer, lock - Spring (3/8")
	850-0101	2	Washer, lock - Spring (1/4")		800-0210	2	Nut, Hex - Brass (3/8-16)
	402-0608	2	Isolator, Vibration		850-0103	2	
	402-0609	2	Isolator, Vibration		871-0028	2	
12		2	Nut, Special (Supplied with Heater)				
13	504-0003	1	Cock, Drain (1/4 NPT)				
14		1	Thermostat				
15		1	Switch, Pressure - Oil				

Engine Coolant Heater (Installed at Generator Assembly Factory)

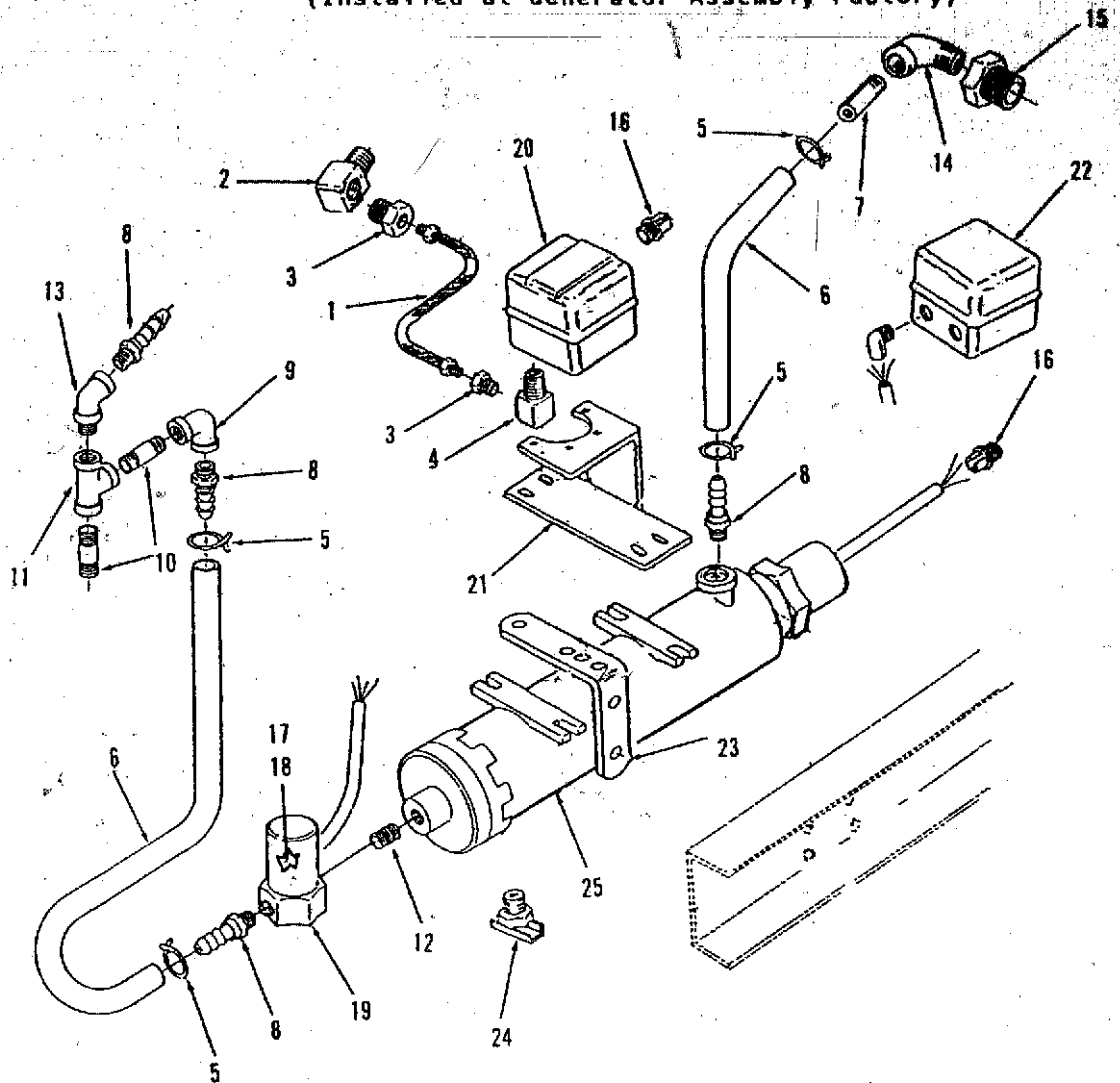

Engine Coolant Heater (Installed at Generator Assembly Factory)

REP NO.	PART NO.	QTY USED	PART DESCRIPTION	REF NO.	PART NO.	QTY USED	PART DESCRIPTION
1	501-0227	1	Line, Fuel	21	333-0224	1	Bracket, Support (Begin 1983)
2	502-0020	1	Elbow, Pipe - Street, 90 Degree		800-0007	4	Attaching Parts for Bracket Screw, Cap - Hex Head (1/4-20 x 1")
3	505-0007	2	Bushing, Reducer - Hex		850-0040	4	Washer, Lock - Spring (1/4")
4	505-0054	1	Elbow, Pipe - Street, 90 Degree		862-0001	4	Nut, Hex (1/4-20)
5	503-0429	4	Clamp, Hose	22			Contactor
6	503-0853	2	Hose		307-1460	1	230 VAC, 3 Pole
7	505-0324	1	Nipple, Pipe - Half		307-1164	1	460 VAC, 3 Pole
8	505-0759	4	Adapter, Hose to Pipe	23	130-1375	2	Bracket, Mounting
9	505-0041	2	Elbow, Pipe - 90 DEG		800-0052	2	Attaching Parts for Bracket Screw, Cap - Hex Head (3/8-16 x 1-1/2")
10	505-0086	2	Nipple, Pipe		862-0003	2	Nut, Hex (3/8-16)
11	505-0304	1	Tee, Pipe		504-0003	1	Cock, Drain
12	505-0004	1	Nipple, Pipe - Close	24			Heater, Electrical
13	505-0333	1	Elbow, Pipe - Street, 45 DEG	25	333-0143	1	4000 Watt, 208 VAC, 1 Phase
14	502-0390	1	Elbow, Pipe - Street, 90 DEG		333-0164	1	4000 Watt, 208 VAC, 3 Phase
15	505-0289	1	Bushing, Reducer - Hex		333-0138	1	4000 Watt, 240 VAC, 1 Phase
16	331-0027	6	Clamp, Cable		333-0190	1	4000 Watt, 240 VAC, 3 Phase
17	323-0957	2	Nut, Wire		333-0150	1	4000 Watt, 277 VAC, 1 Phase
18	332-0149	8	Lug, Terminal		333-0183	1	4000 Watt, 380 VAC, 1 Phase
19	308-0490	1	Switch, Thermostatic		333-0174	1	4000 Watt, 380 VAC, 3 Phase
20	309-0307	1	Switch, Pressure - Oil		333-0161	1	4000 Watt, 480 VAC, 1 Phase
			Attaching Parts for Switch		333-0144	1	4000 Watt, 480 VAC, 3 Phase
	812-0079	4	Screw, Machine - Round Head (#8-32 x 1/2")				
	854-0007	4	Washer, Lock - ET (#8)				

TABLE OF CONTENTS

GENERATOR SECTION

GENERATOR (125,145,150,175 KW SETS ONLY)	32
GENERATOR (190-350KW SETS ONLY)	33
STATOR SECTION OF GENERATOR (125,145,150,175KW SET)	35
STATOR SECTION OF GENERATOR (190-300 & 350KW SETS)	37
STATOR SECTION OF GENERATOR (310KW SET ONLY)	39
GEN ROTOR SECTION (125,145,150,175KW SETS)	41
GEN ROTOR SECTION (190-300 & 350KW SETS)	43
GEN ROTOR SECTION (310KW SET ONLY)	45
BLANK PAGE	46
PERMANENT MAGNET EXCITER	47
OVERSPEED SENSOR	48
OVERSPEED SWITCH	49
BLANK PAGE	50

Generator
125, 145, 150, 175 kW Sets Only

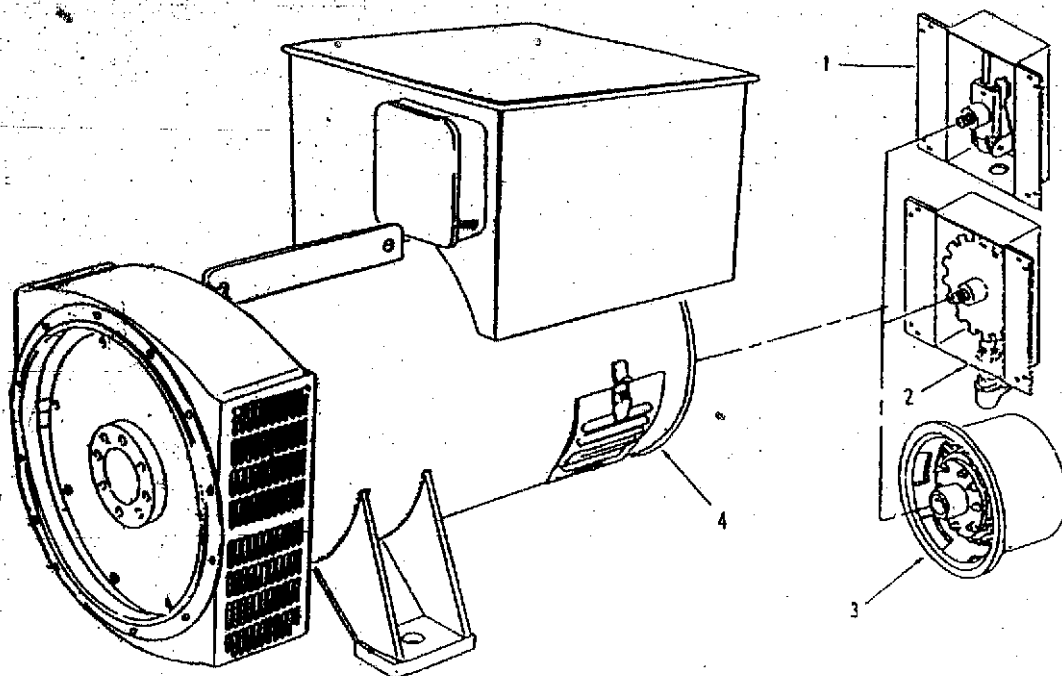

REF NO.	PART NO.	QTY USED	PART DESCRIPTION
1		1	Module, Overspeed Switch (See Separate Page for Components)
	821-2045	4	Attaching Parts Screw, Self-locking - Hex Hd (M8 x 1.25 x 16mm)
2		1	Module, Overspeed Sensor (See Separate Page for Components)
	821-2045	4	Attaching Parts Screw, Self-locking - Hex Hd (M8 x 1.25 x 16mm)
3		1	Module, Permanent Magnet Exciter (See Separate Page for Components)
	249-0298	4	Attaching Parts Screw, Cap - Hex Head (M8 x 16mm)
	249-0218	4	Washer, Lock (M8)
	249-0315	4	Clamp, Retaining

REF NO.	PART NO.	QTY USED	PART DESCRIPTION
4	Note 1		Generator (See Separate Pages for Stator and Rotor Components)
	800-0579	2	Attaching Parts Generator to Chassis Screw, Cap - Hex Head (1-8 x 2-3/4")
	850-0087	2	Washer, Lock - Spring (1")
	526-0084	2	Washer, Flat (1")
	862-0018	2	Nut, Hex (1-8)
	800-0580	12	Adapter to Flywheel Housing Screw, Cap - Hex Head, Gr (7/16-14 x 1-5/8")
	850-0055	12	Washer, Lock - Spring (7/16-14 x 1-5/8")
	800-0553	8	Drive Disc to Flywheel Screw, Cap - Hex Head, Gr (1/2-13 x 1")

Note 1: For replacement Generator please supply the complete Gen Set nameplate and Generator nameplate data.

Generator
190, 200, 220, 230, 250, 275, 300, 310, 350 kW Sets Only

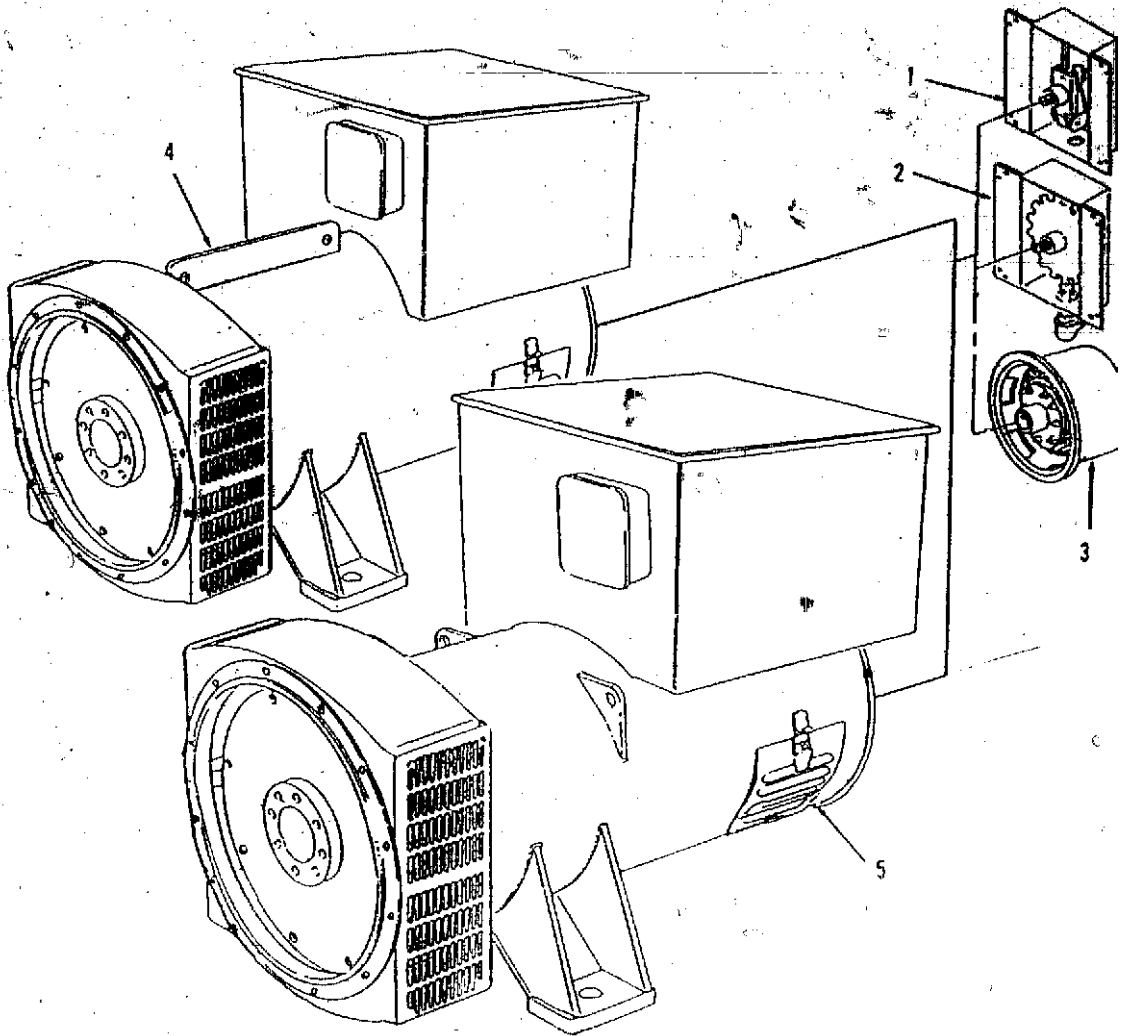

REF NO.	PART NO.	QTY USED	PART DESCRIPTION	REF NO.	PART NO.	QTY USED	PART DESCRIPTION
1		1	Module, Overspeed Switch (See Separate Page for Parts)	4	Note 1		Generator (Above kW's except for item 5)
	821-2045	4	Screw, Self-locking - Hex Hd (M8 x 1.25 x 16mm)	5	Note 1		(See Separate pages for Part Generator (310kW 50Hz Set) (See Separate Pages for Part)
2		1	Module, Overspeed Sensor (See Separate Page for Parts)				Attaching Parts
	821-2045	4	Screw, Self-locking - Hex Hd (M8 x 1.25 x 16mm)	800-0579	2		Generator to Chassis
3		1	Module, Perm. Magnet Exciter (See Separate Page for Parts)	850-0087	2		Screw, Cap - Hex Head (1-8 x 2-3/4")
	249-0298	4	Screw, Cap - Hex Head (M8 x 16mm)	526-0084	2		Washer, Lock - Spring (1")
	249-0218	4	Washer, Lock (M8)	862-0018	2		Washer, Flat (1")
	249-0315	4	Clamp, Retaining				Nut, Hex (1-8)
				800-0580	12		Adapter to Flywheel Housing
				850-0055	12		Screw, Cap - Hex Head.. G (7/16-14 x 1-5/8")
				800-0553	8		Washer, Lock - Spring (7, Drive Disc to Flywheel
							Screw, Cap - Hex Head. G

Generator
Stator Section
125, 145, 150, 175 kW Sets Only

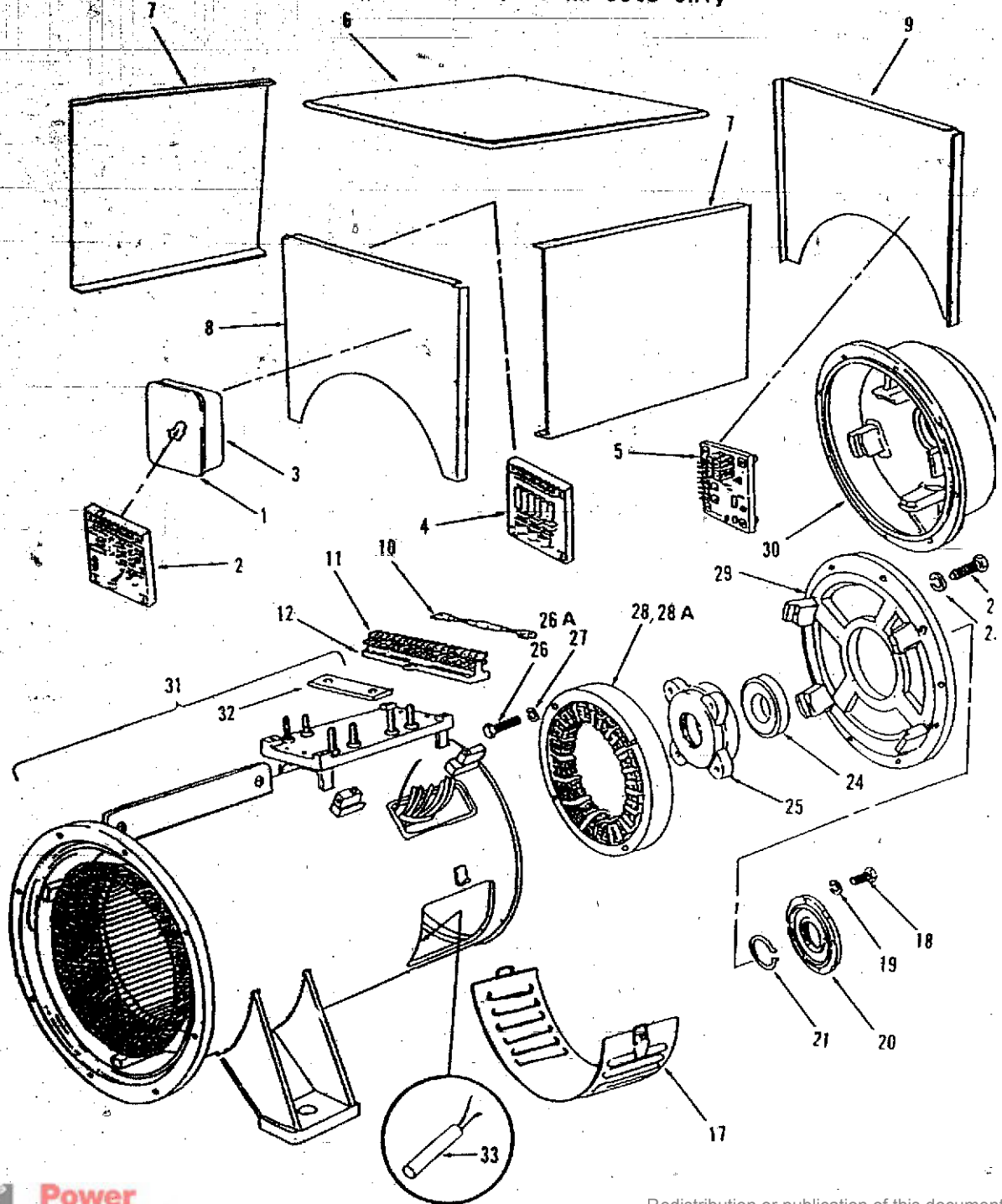

**Power
Generation**

Redistribution or publication of this document
by any means, is strictly prohibited.

**Generator
Stator Section
190,200,220,230,250,275,300,350 kW Sets Only**

REF NO.	PART NO.	QTY USED	PART DESCRIPTION	REF NO.	PART NO.	QTY USED	PART DESCRIPTION
1	249-0631	2	Lid, Electrical Box - Plain	13	249-0438	2	Grille, Inlet - Air
	249-0304	8	Attaching Parts	14	249-0243	4	Screw, Cap - Hex Head (M10 x 30mm)
2	305-0779	1	Screw, Captive	15	249-0202	4	Washer, Lock - Spring (M10)
	305-0770	1	Regulator, Voltage	16	249-0242	1	Cap, Bearing - Outer
	305-0778	1	1 or 3 Phase, Series 4	17	249-0232	1	Circlip
			Excitation(Non PMG)	18	249-0201	8	Screw, Cap - Hex Head (M10 x 35mm)
			1 Phase (Used with PMG)	19	249-0202	8	Washer, Lock - Spring (M10)
			3 Phase (Used with PMG Exciter & 3 Phase Sensing Module)	20	249-0241	1	Bearing, Ball
	249-0398	4	Attaching Parts	21	249-0245	4	Screw, Cap - Hex Head (M10 x 50mm)
3	300-3278	1	Pillar, Threaded	22	249-0202	4	Washer, Lock - Spring (M10)
	249-0398	4	Module, 3 Phase Sensing	23	249-0244	1	Cap, Bearing - Inner
4	249-0395	2	Attaching Parts	24	249-0256	6	Screw, Cap - Hex Head (M6 x 65mm)
5	300-3209-02	1	Pillar, Threaded	25	249-0212	6	Washer, Lock - Spring (M6)
	249-0295	4	Box, Electrical	26	249-0255	1	Stator, Exciter
	249-0288	4	Module, Frequency Detection	27	249-0200	1	Bracket, End
	249-0287	4	Attaching Parts	28	NFS	1	Stator, Generator (Includes Terminal Studs and Links)
6	NFS	1	Screw, Cap - Hex Head (M5 x 35mm)				Attaching Parts Stator to Adapter
7	NFS	2	Washer, Plastic (MS)		249-0204	8	Screw, Cap - Hex Head (M12 x 40mm)
8	NFS	1	Nut, Hex - Nylon (MS)		249-0205	8	Washer, Lock - Spring (M12)
9	NFS	1	Lid	29	249-0200	4	Link, Terminal
10	249-0428	1	Panel, Side		249-0621	1	Heater, Electrical - Replacement
11	249-0289	3	Panel, Front		249-0622	1	70 Watt, 120 VAC
12	249-0424	1	Panel, Rear				70 Watt, 240 VAC
			Resistor (Voltage Code H Only)				
			Block, Terminal - AUX				
			Base, Terminal - AUX				

NFS - Not For Sale

**Generator
Stator Section
190,200,220,230,250,275,300,350 kW Sets Only**

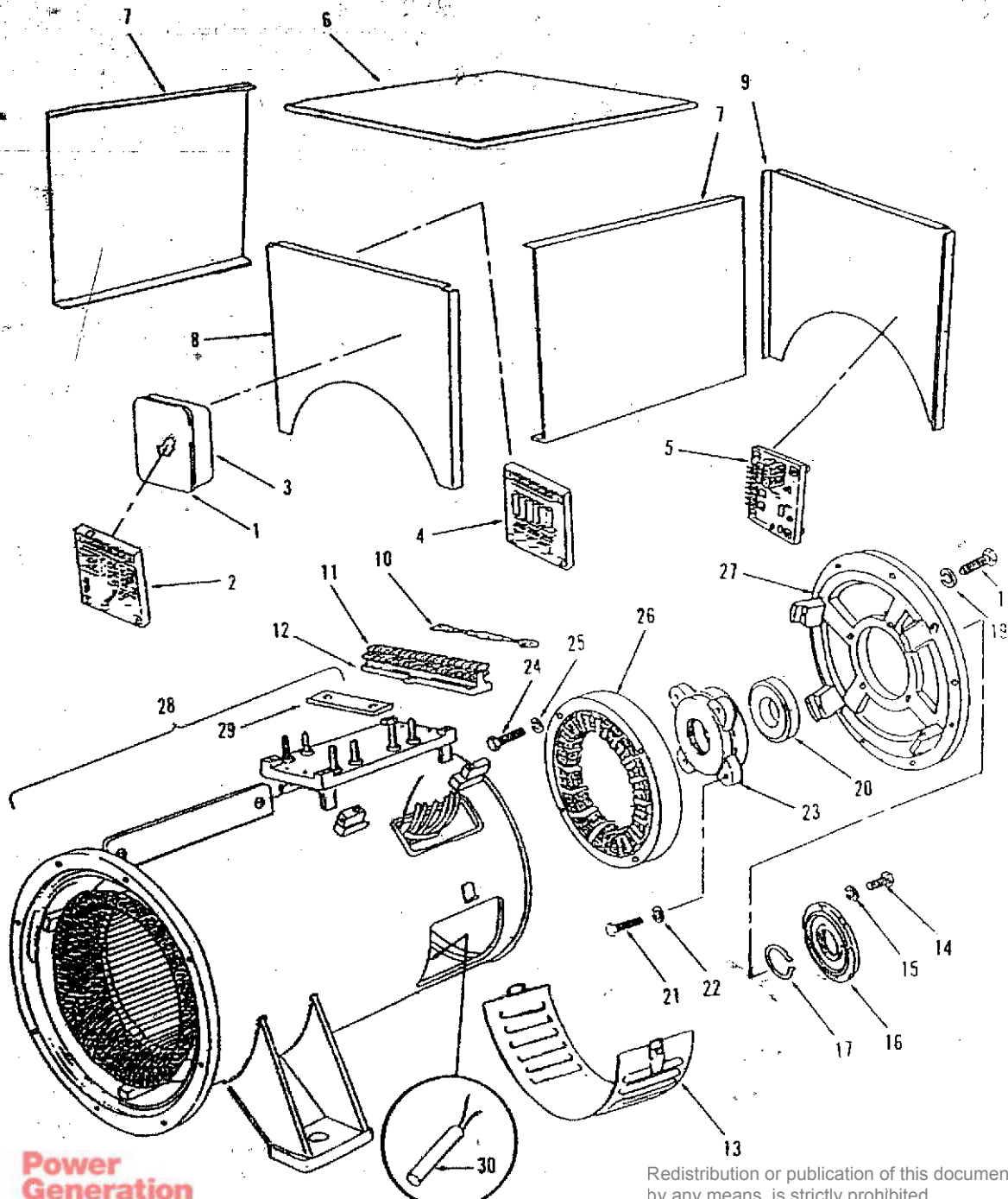

**Generator
Stator Section
190, 200, 220, 230, 250, 275, 300, 350 kW Sets Only**

REF NO.	PART NO.	QTY USED	PART DESCRIPTION	REF NO.	PART NO.	QTY USED	PART DESCRIPTION
1	249-0631	2	Lid, Electrical Box - Plain	13	249-0314	2	Grille, Inlet - Air
	249-0304	8	Attaching Parts	14	249-0243	4	Screw, Cap - Hex Head (M10 x 30mm)
2	305-0779	1	Regulator, Voltage	15	249-0202	4	Washer, Lock - Spring (M10)
	305-0770	1	1 or 3 Phase, Series 4	16	249-0242	1	Cap, Bearing - Outer
	305-0778	1	Excitation (Non PMG)	17	249-0232	1	Circlip
		1	1 Phase (Used with PMG)	18	249-0201	8	Screw, Cap - Hex Head (M10 x 35mm)
		1	3 Phase (Used with PMG Exciter & 3 Phase Sensing Module)	19	249-0202	8	Washer, Lock - Spring (M10)
	249-0398	4	Attaching Parts	20	249-0241	1	Bearing, Ball
3	300-3278	1	Pillar, Threaded	21	249-0245	4	Screw, Cap - Hex Head (M10 x 50mm)
		1	Module, 3 Phase Sensing	22	249-0202	4	Washer, Lock - Spring (M10)
	249-0398	4	Attaching Parts	23	249-0244	1	Cap, Bearing - Inner
4	249-0395	2	Pillar, Threaded	24	249-0256	6	Screw, Cap - Hex Head (M6 x 65mm)
5	300-3209-02	1	Box, Electrical	25	249-0212	6	Washer, Lock - Spring (M6)
		1	Module, Frequency Detection	26	249-0255	1	Stator, Exciter
	249-0295	4	Attaching Parts	27	249-0200	1	Bracket, End
		4	Screw, Cap - Hex Head (M5 x 35mm)	28	NFS	1	Stator, Generator (Includes Terminal Studs and Links)
	249-0288	4	Washer, Plastic (M5)				Attaching Parts Stator to Adapter
	249-0287	4	Nut, Hex - Nylon (M5)		249-0204	8	Screw, Cap - Hex Head (M12 x 40mm)
6	NFS	1	Lid		249-0205	8	Washer, Lock - Spring (M12)
7	NFS	2	Panel, Side	29	249-0200	4	Link, Terminal
8	NFS	1	Panel, Front	30			Heater, Electrical - Replace
9	NFS	1	Panel, Rear		249-0621	1	70 Watt, 120 VAC
10	249-0428	1	Resistor (Voltage Code H Only)		249-0622	1	70 Watt, 240 VAC
11	249-0289	3	Block, Terminal - AUX				
12	249-0424	1	Base, Terminal - AUX				

NFS - Not For Sale

Generator Stator Section 310 kW Set Only

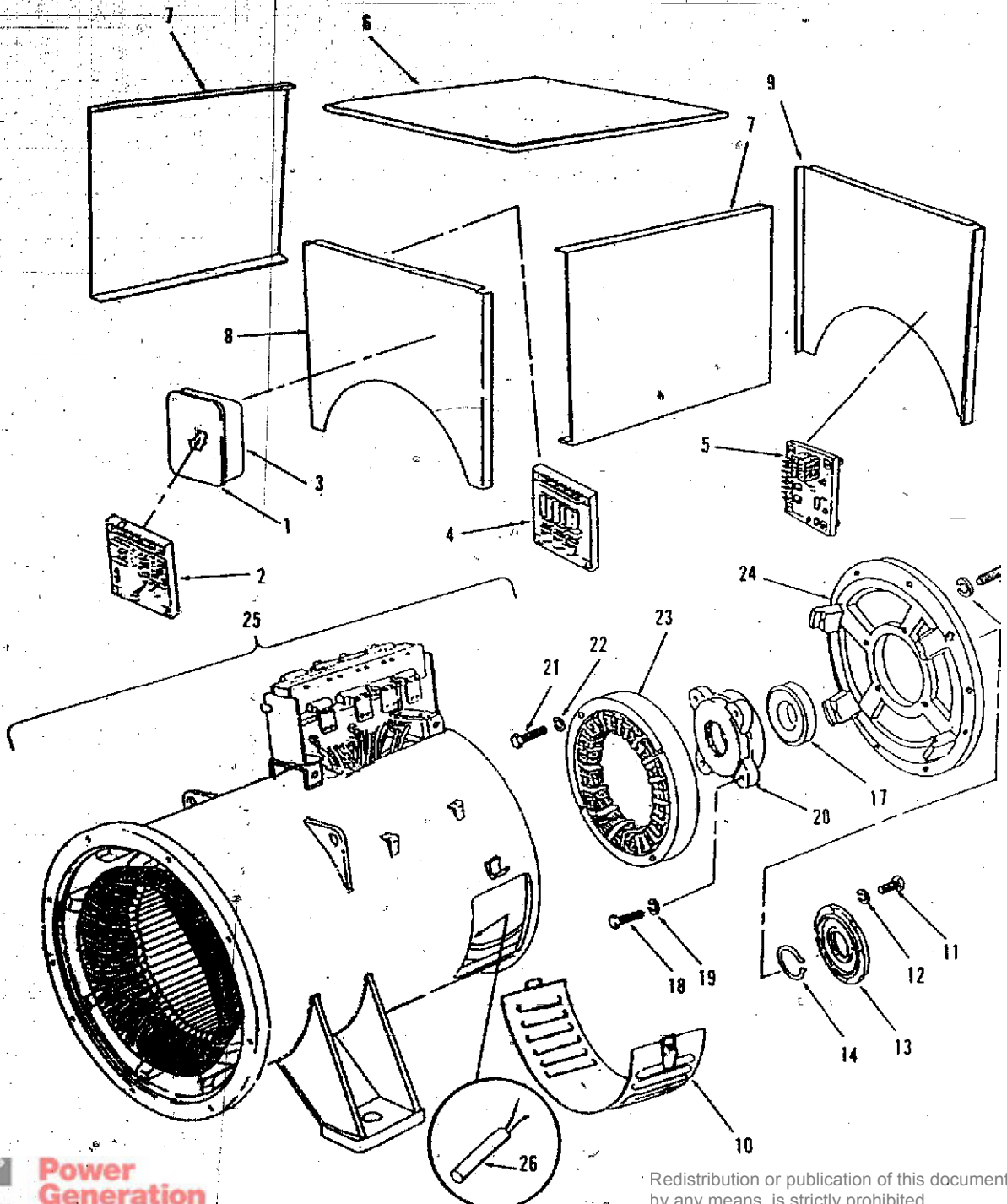

**Generator
Stator Section
310 kW Set Only**

REF NO.	PART NO.	QTY USED	PART DESCRIPTION	REF NO.	PART NO.	QTY USED	PART DESCRIPTION
1	249-0631	2	Lid, Electrical Box - Plain	12	249-0202	8	Washer, Lock - Spring (M10)
	249-0304	8	Attaching Parts	13	249-0242	1	Cap. Bearing - Outer
			Screw, Captive	14	249-0232	1	Circlip
2	305-0770	1	Regulator, Voltage	15	249-0248	4	Screw, Cap - Hex Head
	305-0778	1	Standard				(M10 x 30mm)
			3 Phase (Used with	16	249-0202	4	Washer, Lock - Spring (M10)
			PMG Exciter & 3 Phase	17	249-0241	1	Bearing, Ball
			Sensing Module)	18	249-0245	4	Screw, Cap - Hex Head
			Attaching Parts				(M10 x 50mm)
	249-0398	4	Pillar, Threaded	19	249-0202	4	Washer, Lock - Spring (M10)
3	300-3278	1	Module, 3 Phase Sensing	20	249-0244	1	Cap. Bearing - Inner
			Attaching Parts	21	249-0256	6	Screw, Cap - Hex Head
	249-0398	4	Pillar, Threaded				(M6 x 85mm)
4	249-0395	2	Box, Electrical	22	249-0212	6	Washer, Lock - Spring (M6)
5	300-3209-02	1	Module, Frequency Detection	23	249-0255	1	Stator, Exciter
			Attaching Parts	24	249-0272	1	Bracket, End
	249-0295	4	Screw, Cap - Hex Head	25	NFS	1	Stator, Generator (Include
			(M5 x 35mm)				Terminal Studs and Links)
	249-0288	4	Washer, Plastic (M5)				Attaching Parts Stator
	249-0287	4	Nut, Hex - Nylon (M5)				to Adapter
6	NFS	1	Lid		249-0268	8	Screw, Cap - Hex Head
7	NFS	2	Panel, Side				(M12 x 35mm)
8	NFS	1	Panel, Front		249-0205	8	Washer, Lock - Spring (M
9	NFS	1	Panel, Rear	26			Heater, Electrical - Repla
10	249-0408	2	Grille, Inlet - Air		249-0621	1	70 Watt, 120 VAC
11	249-0201	8	Screw, Cap - Hex Head		249-0622	1	70 Watt, 240 VAC
			(M10 x 35mm)				

NFS - Not For Sale

**Generator
Rotor Section
125, 145, 150, 175 kW Sets Only**

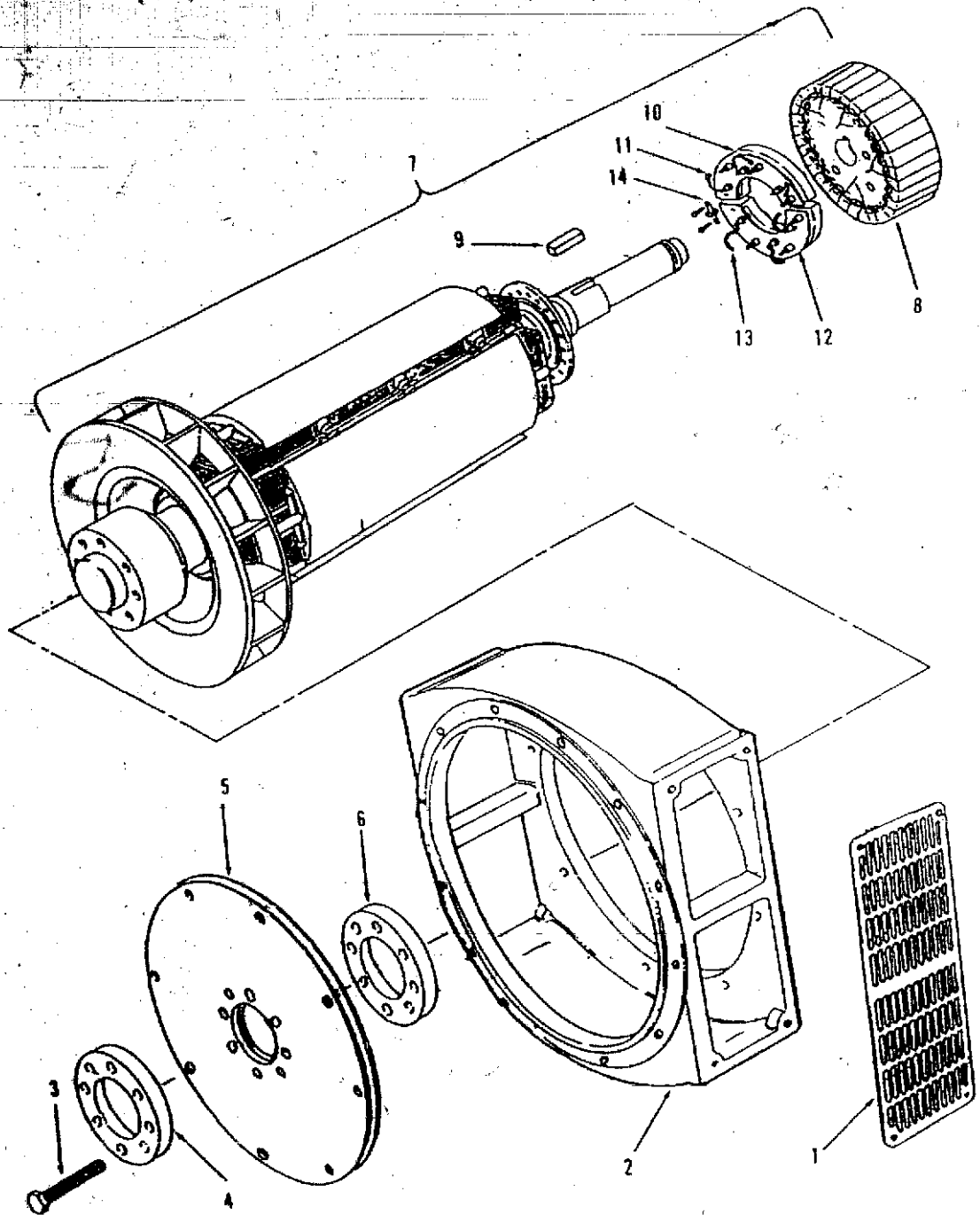

**Power
Generation**

Redistribution or publication of this document
by any means, is strictly prohibited.

**Generator
Rotor Section
125, 145, 150, 175 kW Sets Only**

REF NO.	PART NO.	QTY USED	PART DESCRIPTION	REF NO.	PART NO.	QTY USED	PART DESCRIPTION
1	249-0371	2	Screen, Air - Adapter Attaching Parts	8	249-0336	1	Rotor, Exciter (Does Not Include Rectifier Assy)
	249-0294	8	Screw, Cap - Hex Head (M5 x 12mm)	9	249-0271	1	Key
	249-0307	8	Washer, Lock - Spring (M5)	10	249-0340	1	Rectifier Assy, Forward (Includes Item 11 Diodes)
	249-0308	8	Washer, Flat (M5)	11	249-0281	3	Diode, Forward Polarity
2	249-0369	1	Adapter, Generator (SAE1)	12	249-0341	1	Rectifier Assy, Reverse (Includes Item 13 Diodes)
3	249-0292	8	Screw, Cap - Hex Head (M16 x 60mm)	13	249-0282	3	Diode, Reverse Polarity
4	249-0402	1	Plate, Pressure	14	249-0283	1	Varistor
5	249-0328	3	Disc, Drive (SAE14)		249-0294	2	Attaching Parts Screw, Cap - Hex Head (M5 x 12mm)
6	249-0363	1	Spacer				
7	NFS	1	Rotor, Generator (Includes Exciter, Key, and Rectifier Assemblies)				

NFS - Not For Sale

**Generator
Rotor Section
190, 200, 20, 230, 250, 275, 300, 350 kW Sets Only**

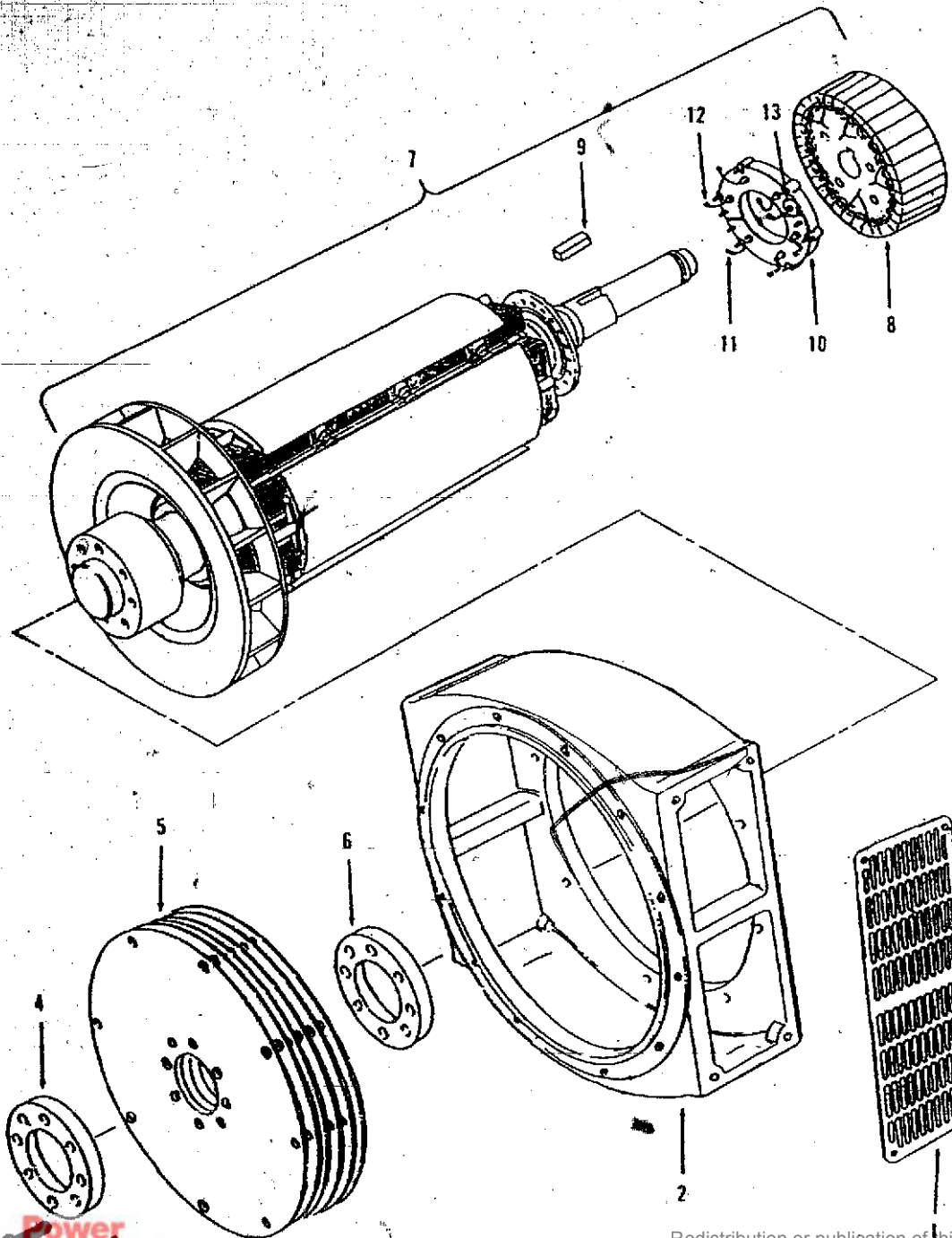

**Generator
Rotor Section
190, 200, 20, 230, 250, 275, 300, 350 kW Sets Only**

REF NO.	PART NO.	QTY USED	PART DESCRIPTION	REF NO.	PART NO.	QTY USED	PART DESCRIPTION
1	249-0311	2	Screen, Air - Adapter Attaching Parts	7	NFS	1	Rotor, Generator (includes Exciter, Key, and Rectifier Assemblies)
	249-0294	12	Screw, Cap - Hex Head (M5 x 12mm)	8	249-0321	1	Rotor, Exciter (Does Not Include Rectifier Assy)
	249-0307	12	Washer, Lock - Spring (M5)	9	249-0271	1	Key
	249-0385	12	Washer, Flat (M5)	10	249-0237	1	Rectifier Assy (Includes Diodes)
2	249-0436	1	Adapter, Generator SAE 1	11	249-0239	3	Diode, Forward Polarity
3	249-0293	8	Screw, Cap - Hex Head (M20 x 65mm)	12	249-0238	3	Diode, Reverse Polarity
4	249-0230	1	Plate, Pressure	13	249-0240	1	Varistor
5	249-0397	4	Disc, Drive SAE 14				
6	249-0396	1	Spacer				

NFS - Not For Sale

Generator
Rotor Section
310 kW Set Only

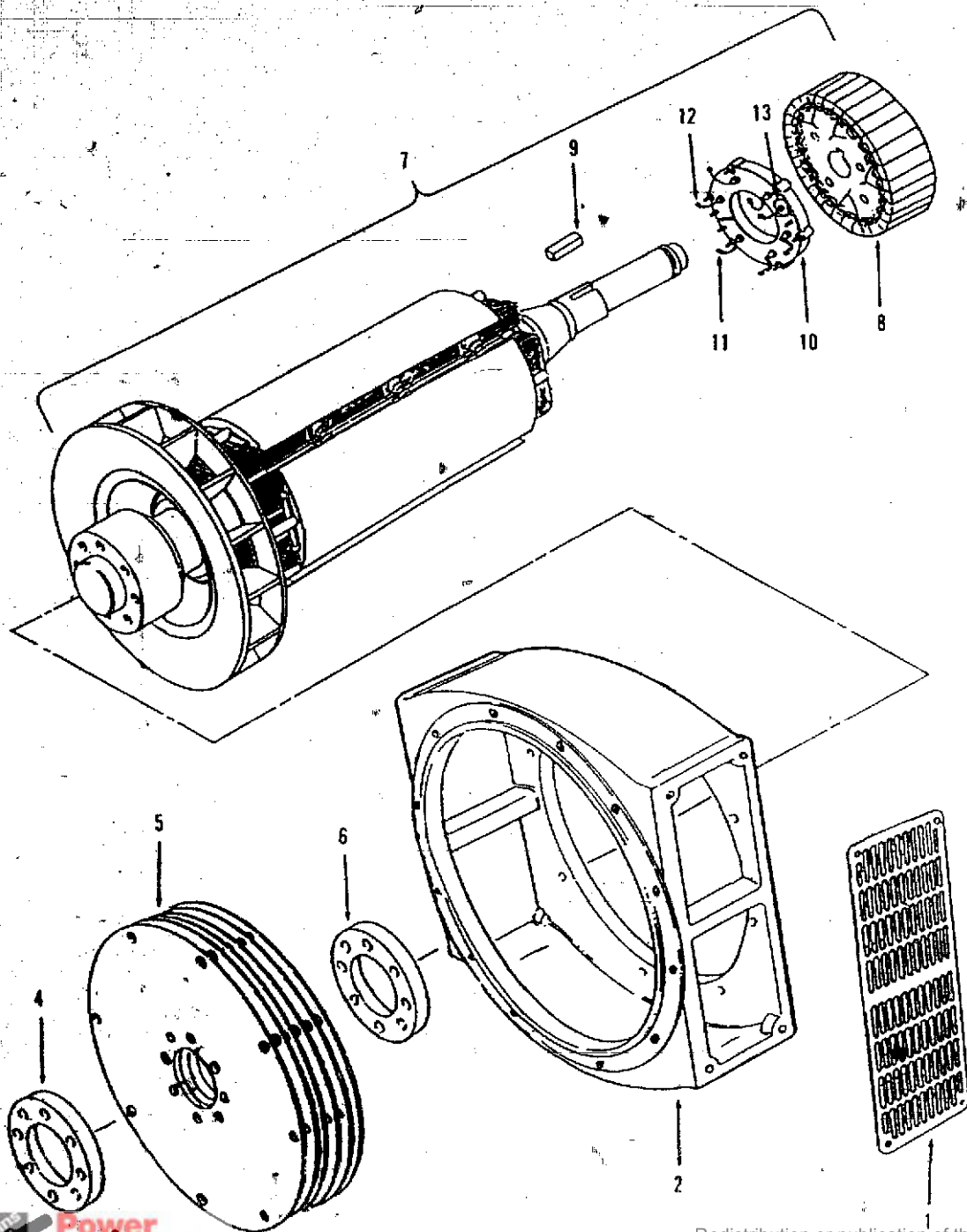

**Generator
Rotor Section
310 kW Set Only**

REF NO.	PART NO.	QTY USED	PART DESCRIPTION	REF NO.	PART NO.	QTY USED	PART DESCRIPTION
1	249-0408	2	Screen, Air - Adapter	7	NFS	1	Rotor, Generator (Includes
	249-0294	12	Attaching Parts				Exciter, Key, and Rectifi
			Screw, Cap - Hex Head	8	249-0522	1	Assemblies)
			(M5 x 12mm)				Rotor, Exciter (Does Not
	249-0307	12	Washer, Lock - Spring (M5)	9	249-0271	1	Include Rectifier Assy)
	249-0365	12	Washer, Flat (M5)	10	249-0237	1	Key
2	249-0521	1	Adapter, Generator SAE 1				Rectifier Assy
3	249-0437	8	Screw, Cap - Hex Head				(Includes Diodes)
			(M20 x 75mm)	11	249-0239	3	Diode, Forward Polarity
4	249-0230	1	Plate, Pressure	12	249-0238	3	Diode, Reverse Polarity
5	249-0397	4	Disc, Drive SAE 14	13	249-0240	1	Varistor
6	249-0463	1	Spacer				

NFS - Not For Sale

Generator Permanent Magnet Exciter

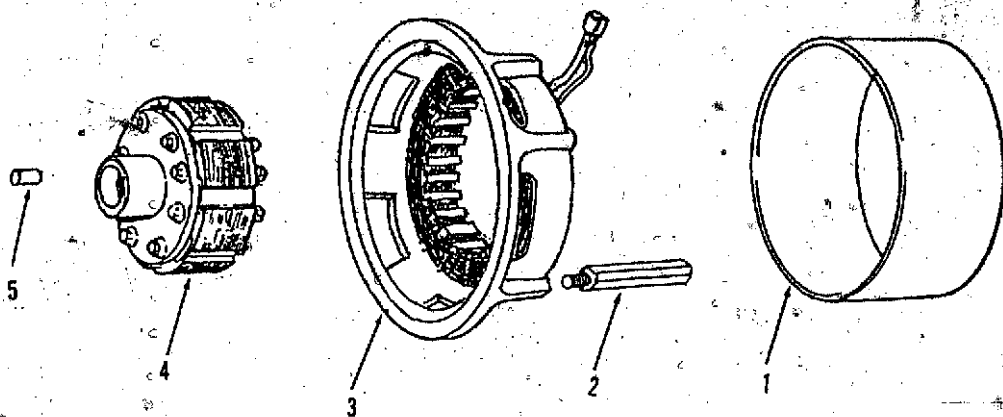

REF NO.	PART NO.	QTY USED	PART DESCRIPTION
1	249-0497	1	Cover
	249-0294	3	Screw, Cap - Hex Head (M5 x 12mm)
	249-0307	3	Washer, Lock (M5)
2	249-0496	3	Pillar, Threaded
3	249-0426	1	Stator, Exciter with Frame

REF NO.	PART NO.	QTY USED	PART DESCRIPTION
4	249-0427	1	Rotor, Exciter
	249-0644	1	Frame 2, 3, 4 Generator
	249-0399	1	Frame 5, 6, 7 Generator
	249-0202	1	Attaching Parts for Rotor
5	249-0313	1	Bolt
		1	Washer, Lock (M10)
		1	Pin, Dowel



**Power
Generation**

Redistribution or publication of this document by any means, is strictly prohibited.

Generator Overspeed Sensor

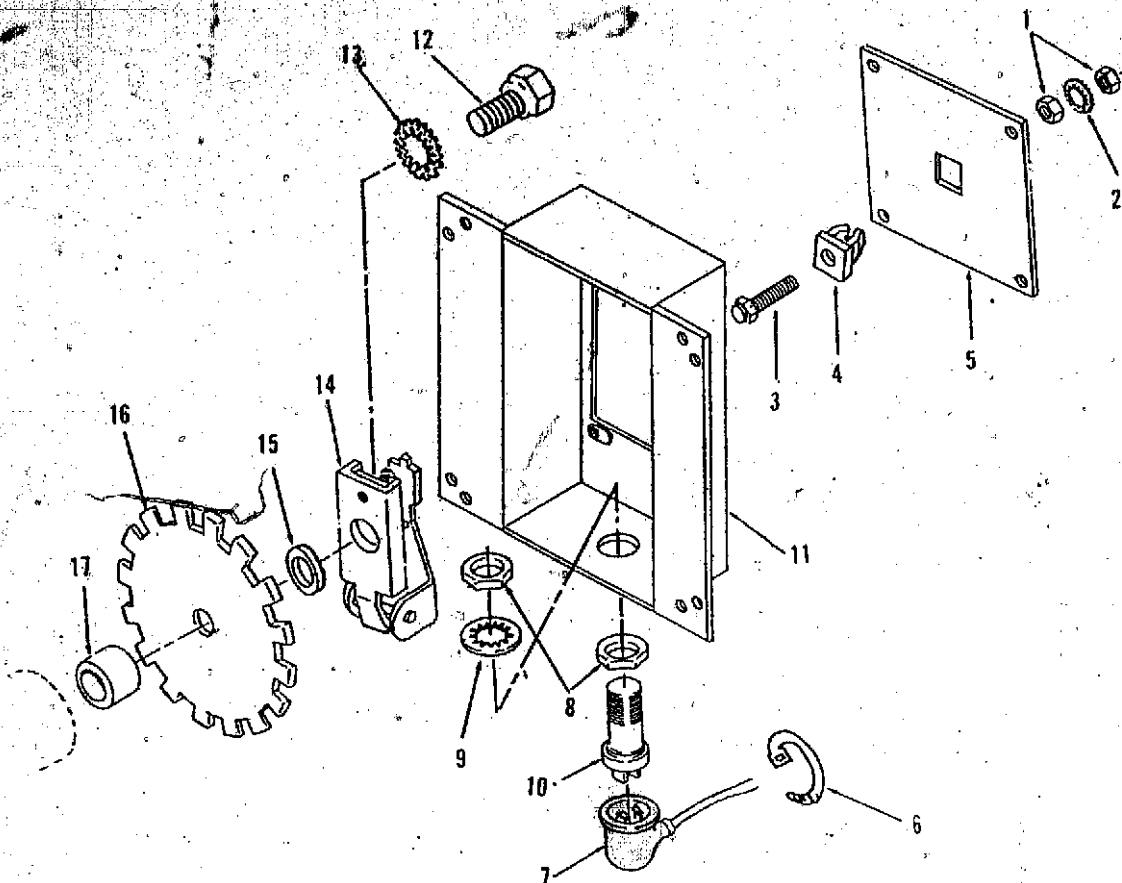

REF NO.	PART NO.	QTY USED	PART DESCRIPTION
1	862-0001	2	Nut, Hex (1/4-20)
2	853-0013	1	Washer, Lock - EIT (1/4")
3	150-0723	1	Point, Overspeed
4	870-0250	1	Nut, Insulated
5	150-2206	1	Plate, Mounting
	821-0005	4	Screw, Self-locking - Hex (#10-32 x 1/2")
6	332-1445	5	Tie, Cable
7	338-2189-02	1	Harness, Wiring
8	868-0011	2	Nut, Jam - Hex (3/4-16)

REF NO.	PART NO.	QTY USED	PART DESCRIPTION
9	854-0031	1	Washer, Lock - IT (3/4")
10	150-1406	1	Sensor, Speed
11	150-2207	1	Cover, Overspeed Switch
12	718-1058	1	Screw, Cap - Hex Head (M10 x 1.5 x 45mm)
13	858-0010	1	Washer, Lock - EIT (3/8")
14	150-0956	1	Switch, Overspeed
15	370-4031	1	Spacer, Sleeve
16	150-2204	1	Wheel - Speed Sensor
17	370-4032	1	Spacer, Sleeve

Generator Overspeed Switch

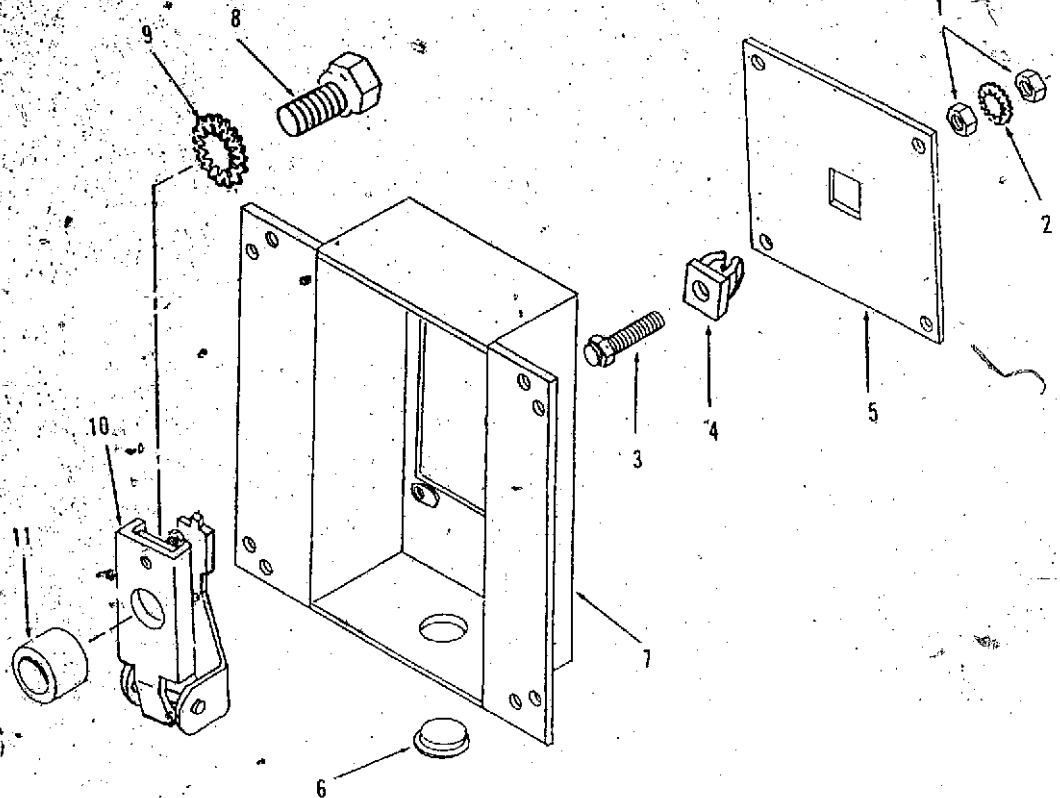

REF. NO.	PART NO.	QTY. USED	PART DESCRIPTION
1	862-0001	2	Nut, Hex (1/4-20)
2	853-0013	1	Washer, Lock - EIT (1/4")
3	150-0723	1	Point, Overspeed
4	870-0250	1	Nut, Insulated
5	150-2206	1	Plate, Mounting
	821-0005	4	Screw, Self-locking - Hex (#10-32 x 1/2")

REF. NO.	PART NO.	QTY. USED	PART DESCRIPTION
6	517-0136	1	Plug, Plastic
7	150-2207	1	Cover, Overspeed Switch
8	718-1058	1	Screw, Cap - Hex Head (M10 x 1.5 x 45mm)
9	856-0010	1	Washer, Lock - EIT (3/8")
10	150-0956	1	Switch, Overspeed
11	370-4032	1	Spacer, Sleeve

TABLE OF CONTENTS
SET CONTROLS

GENERATOR SET CONTROL (WITH HOUSING ENCLOSURE)	53
ENGINE CONTROL COMPONENTS (SETS WITH HOUSING ENCLOSURE)	55
GENERATOR CONTROL COMPONENTS (SETS WITH HOUSING ENCLOSURE)..	57
CONTROL HEATER (SETS WITH HOUSING ENCLOSURE)	58
POTENTIAL TRANSFORMER (SETS WITH HOUSING ENCLOSURE	59
WATTMETER (SETS WITH HOUSING ENCLOSURE)	61
GENERATOR SET CONTROL (WITHOUT HOUSING ENCLOSURE).....	63
ENGINE CONTROL COMPONENTS (SETS WITHOUT HOUSING ENCLOSURE)..	65
GENERATOR CONTROL COMPONENTS(SETS WITHOUT HOUSING ENCLOSURE)	67

Generator Set Control (With Housing Enclosure)

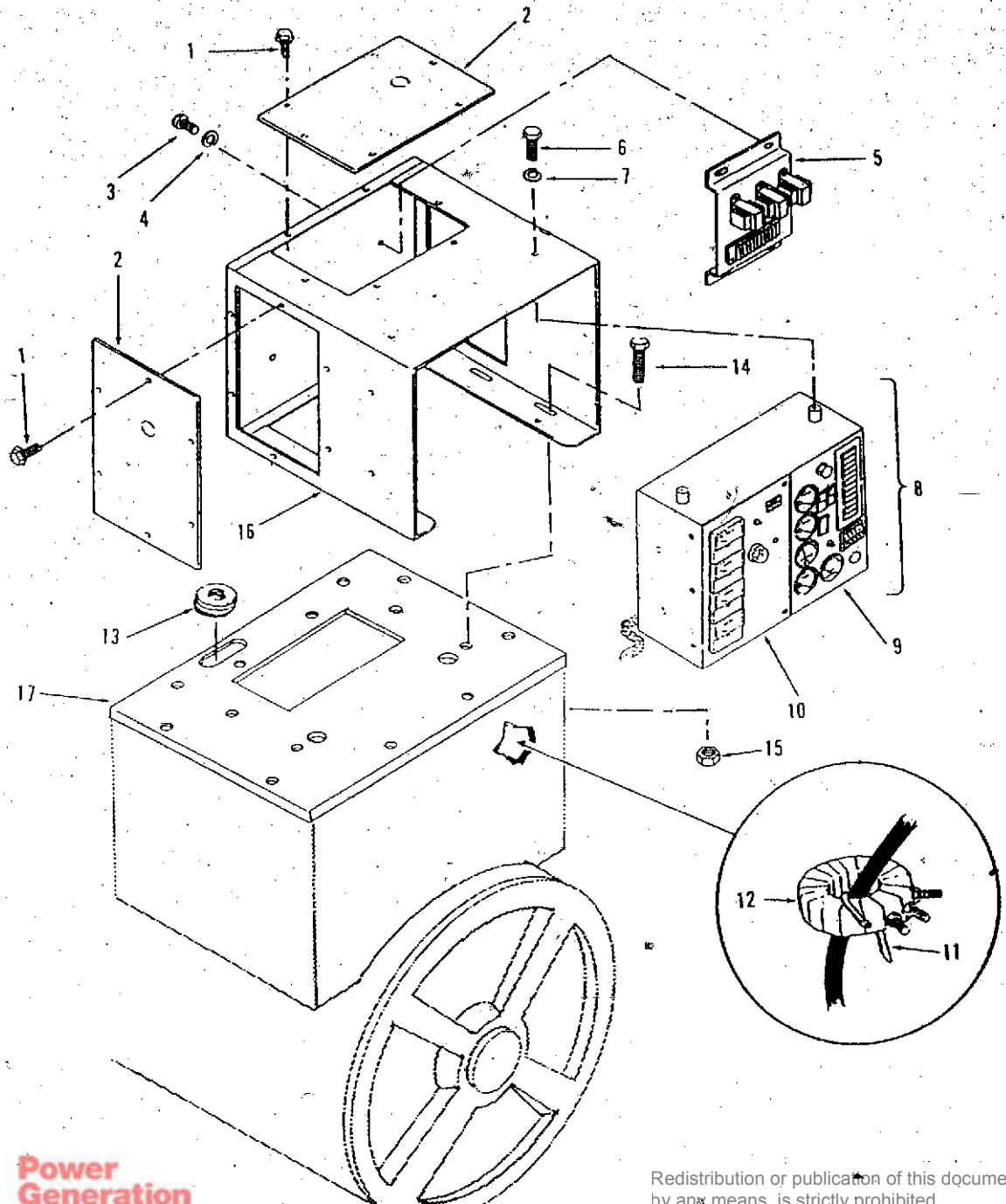

Generator Set Control (With Housing Enclosure)

REF NO.	PART NO.	QTY USED	PART DESCRIPTION	REF NO.	PART NO.	QTY USED	PART DESCRIPTION
1	821-0005	18	Screw, Self-locking - Hex (#10-32 x 1/2")		302-1795-05	3	125kW Voltage Code Z, 175 & 200kW Voltage Code H, 350kW Voltage Code H.
2	NFS	3	Panel, Box - Control [319-0077]		302-1794-07	3	145, 165, 190kW Volt. Code Z, 150, 175, 200kW Volt. Code L.
3	812-0156	4	Screw, Machine - Round Head (1/4-20 x 1/2")		302-1794-08	3	220kW Volt. Code Z 208/480V, 230kW Volt. Code L 208/480V.
4	850-0040	4	Washer, lock - Spring (1/4")		302-1794-09	3	220kW Voltage Code Z 380V, 230kW Voltage Code L 380V, 250kW Voltage Code L.
5	NFS	1	Transformer Assy. Potential (See Separate Page for Components)		302-1794-10	3	275kW Voltage Code Z, 300kW Voltage Code L, 310kW Voltage Code Z.
6	800-0051	4	Screw, Cap - Hex Head (5/16-18 x 1/2")		302-1794-11	3	350kW Voltage Code L
7	850-0045	4	Washer, Lock - Spring (5/16")	13	508-0051	1	Grommet
8	NFS	1	Control, Set (See item 9 & 10 for Components)	14	870-0212	6	Nut, Self-locking - Hex
9	NFS	1	Control, Engine (See Separate Page for Components)	15	821-0018	6	Screw, Self-locking - Hex Head (1/4-20 x 5/8")
10	NFS	1	Control, Generator (See Separate Page for Components)	16	NFS	1	Housing, Control [301-3155]
11	332-0941	6	Tie, Cable	17	NFS	1	Adapter, Housing to Terminal Box
12			Transformer, Current - Reconnectible		NFS	1	125/145kW Volt. Code Z, 150 & 175kW Volt. Code L & H, [319-0011]
	302-1794-02	3	150kW Voltage Code H		NFS	1	160 to 310kW Volt. Code Z, 200 to 350kW Volt. Code L & H [319-0012]
	302-1794-03	3	230kW Voltage Code H				
	302-1794-04	3	250 & 300kW Voltage Code H				

NFS - Not For Sale

Engine Control Components (Sets with Housing Enclosure)

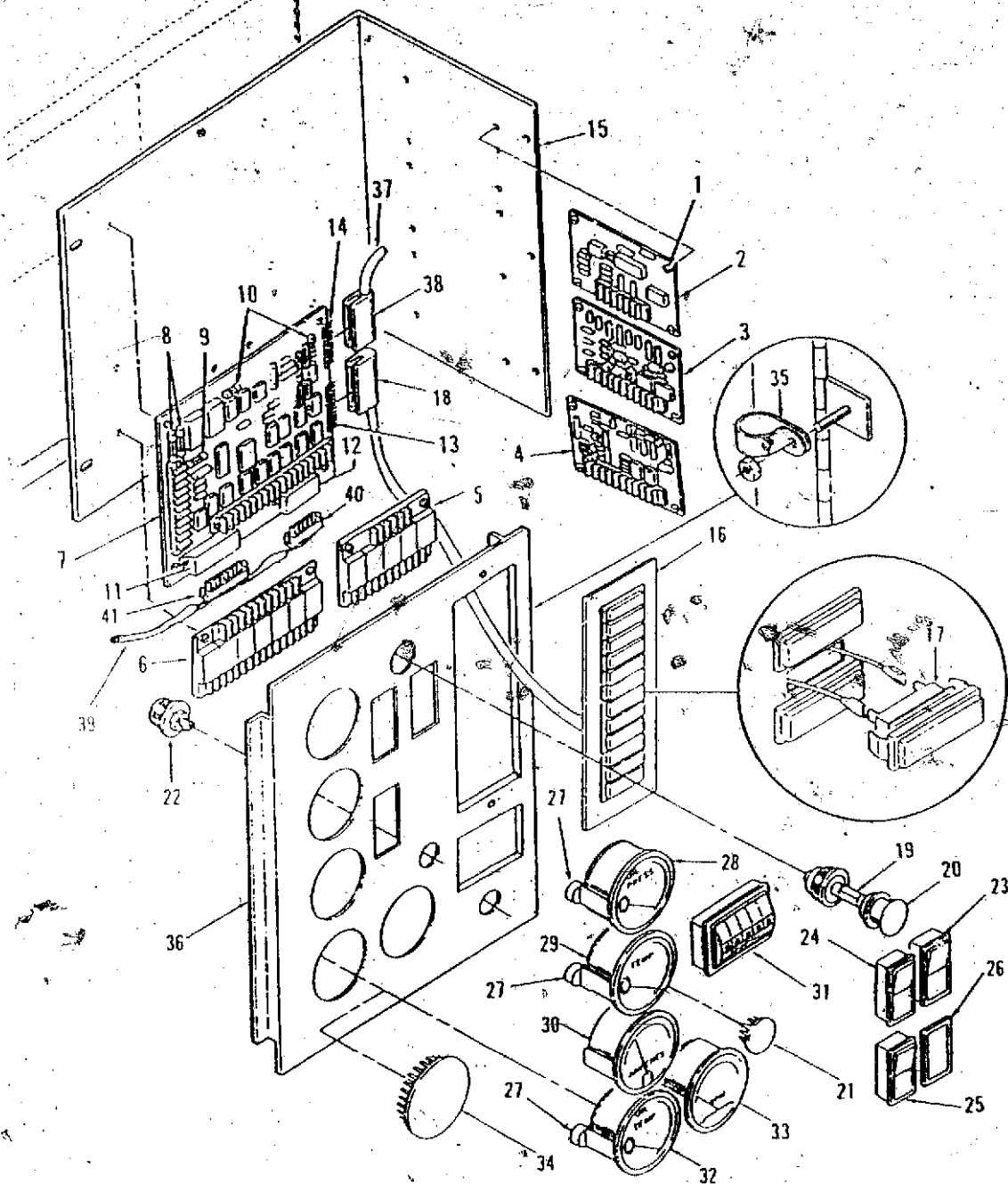

Engine Control Components (Sets with Housing Enclosure)

REF NO.	PART NO.	QTY USED	PART DESCRIPTION	REF NO.	PART NO.	QTY USED	PART DESCRIPTION
1	815-0544	24	Screw, Machine - Round Head With IT Lock Washer (#6-32 x 1/2")	17	322-0369-02	12	Lamp, Incandescent - 1/3 Watt 28 VDC
2	300-2899	1	Board, Time Delay	18	323-1310	1	Housing, 13 Pin (J3)
3			Start/Stop - 24 VDC (A15)	19	323-1302	13	Contact, Pin
			Board, Magnetic Sensor		322-0017	1	Lamp, Incandescent - 28 VDC (DS11)
			Start Disconnect/Over Speed Sensor (A16)	20	322-0361	1	Holder, Lamp
	300-2903	1	Standard	21	517-0131	1	Plug, Button
	300-2904	1	Precision	22	303-0280	1	Potentiometer (R11)
4	300-2906	1	Board, Over-Under Voltage Sensor - 24 VDC (A17)	23	308-0785	1	Switch, Push (S11)
5	300-2856	1	Board, Relay - 24 VDC (A13)	24	308-0784	1	Switch, Push (S12)
6	300-2863	1	Board, Relay - 24 VDC (A14)	26	301-6257	1	Cover
7			Board, Engine Monitor (A11) (Includes Fuses and Connectors)	27	193-0250	3	Resistor, Gauge (R12)
	300-2808	1	24 VDC, 2 Light	28	193-0352	1	Gauge, Pressure - Oil (M11)
	300-2812	1	24 VDC, 12 Light	29	193-0351	1	Gauge, Temperature - Water (M12)
8	321-0270	2	Fuse, Cartridge - 20 Amp (F1, F2)	30	302-1790	1	Ammeter (M13)
9	321-0231	1	Fuse, Cartridge - 15 Amp (F3)	31	302-0885	1	Meter, Totalizing Time (M14)
10	321-0094	2	Fuse, Cartridge - 5 Amp (F4, F5)		815-0385	2	Screw, Machine - Round Head (#6-31 x 1/2")
11	323-1305	1	Connector, 8 Pin (P1)		870-0183	2	Nut, Hex with E Lockwasher (#6-32)
12	323-1303	1	Connector, 6 Pin (P2)	32	193-0330	1	Gauge, Temperature - Oil (M15)
13	323-1309	1	Connector, 13 Pin (P3)	33	302-1873-01	1	Tachometer (M16)
14	323-1307	1	Connector, 12 Pin (P4)	34	517-0221	1	Plug, Button
15	NFS	1	Bracket, Mounting [301-8851]	35	332-0052	1	Clamp, Loop
	821-0004	4	Screw, Self-locking - Hex Hd (#10-32 x 5/16")		870-0131	1	Nut, Hex with E Lockwasher (#10-32 x 1/2")
16			Module, Indicator - Fault (Includes replaceable lamps, Harness with connector housing & contact pins) (A12)	36	NFS		Door, Control [301-9055-01]
	322-0358-02	1	24 VDC, 2 Light	37	338-1817	1	Harness, Wiring - DC Meter (Includes Connector & Pins)
	322-0360-02	1	24 VDC, 12 Light	38	323-1308	1	Housing, 12 Pin (J4)
	815-0385	2	Screw, Machine - Round Head (#6-32 x 1/2")		323-1302	12	Contact, Pin
	870-0183	2	Nut, Self-locking - Hex (#6-32)	39	338-2067	1	Harness, Wiring - Control to Engine (Includes Connectors and Pins)
				40	323-1304	1	Housing, 6 Pin
					323-1200	8	Contact, Pin
				41	323-1306	1	Housing, 8 Pin
					323-1200	8	Contact, Pin

NFS - Not For Sale

Generator Control Components (Sets with Housing Enclosure)

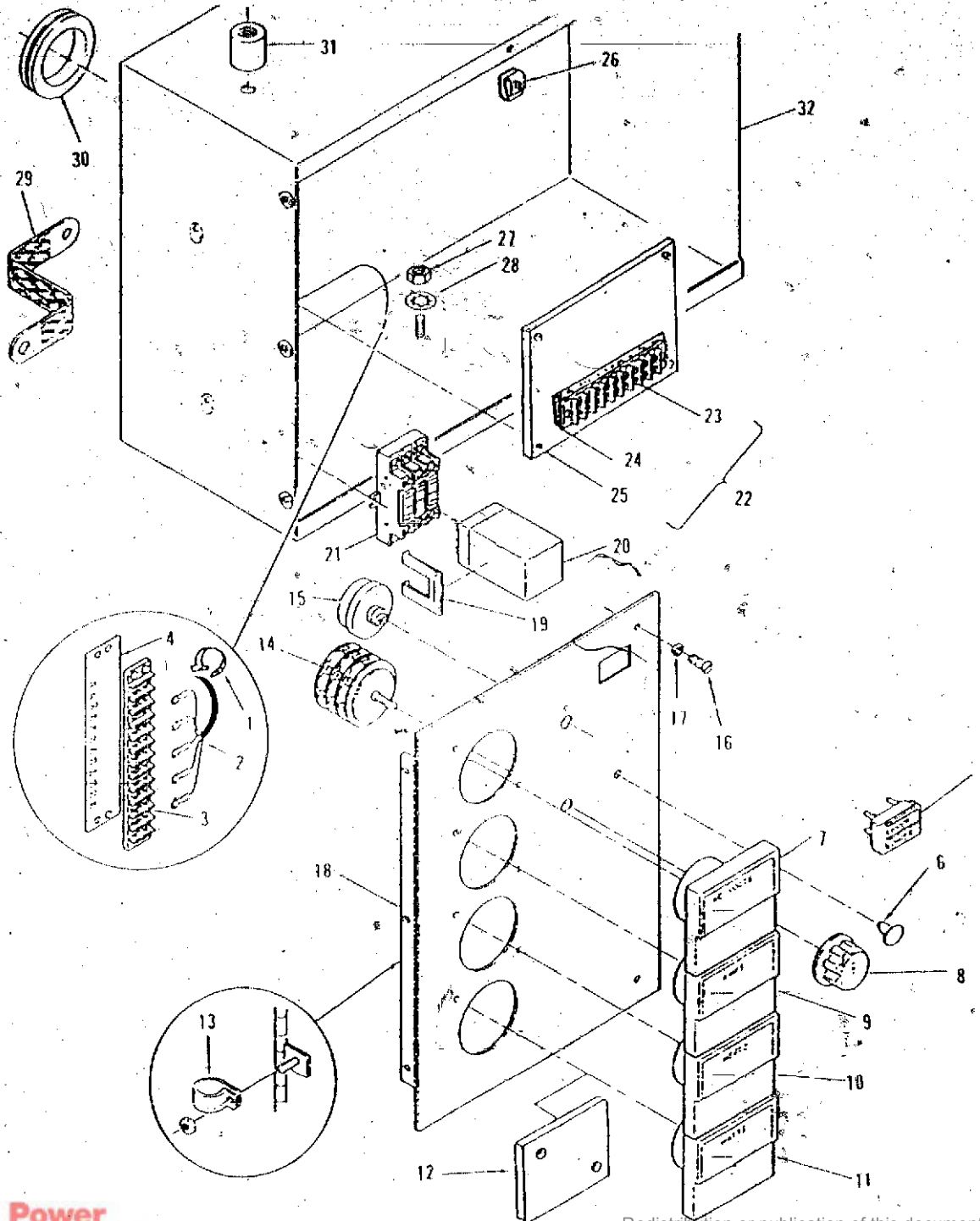

Generator Control Components (Sets with Housing Enclosure)

REF NO.	PART NO.	QTY USED	PART DESCRIPTION	REF NO.	PART NO.	QTY USED	PART DESCRIPTION
1	332-1445	2	Tid. Cable	13	332-0052	1	Clamp, Loop
2	338-1818	1	Harness, Wiring		870-0131	1	Nut, Self-locking - Hex with
	338-1853	1	Control with Meters	14	308-0284	1	ET Lock Washer (#10-32)
	812-0065	2	(Includes Terminal Block)	15	303-0261	1	Switch, Rotary (S21)
		1	Control without Meters	16	406-0334	2	Rheostat (R21)
		2	Screw, Machine - Round Head	17	406-0333	2	Clip, Fastener
			(#6-32 x 5/8")	18	NFS	1	Stud, Fastener
3	332-0607	1	Block, Terminal (TB1)		821-0004	3	Door, Control [301-9054-01]
4	332-2723	1	Strip, Marker				Screw, Self-locking - Hex
5	322-0363	1	Light, Indicator, Dual	19	307-1987	2	(#10-32 x 5/16")
			(DS21, DS22)	20	307-1056	1	Clip, Relay
6	517-0131	1	Plug, Button	21	323-0804	1	Relay, 24 VDC (K21)
7	302-1148	1	Voltmeter (M21)		815-0544	2	Socket, Relay
	302-1753	1	Dual Scale 0-300/0-600V				Screw, Machine - Round Head
	303-0032	1	Single Scale 0-750V				with IT Lock Washer
8			Knob	22	NFS	1	(#6-32 x 1/2")
9			Ammeter (M22)		812-0065	4	Terminal Board Assembly
	302-1176	1	Single Scale Voltage Code H				Screw, Machine - Round Head
	302-1761	1	125kW, 0-200 Amp	23	332-0751	1	(#6-32 x 5/8")
	302-1686	1	175 & 200kW, 0-250 Amp		812-0066	2	Block, Terminal
	302-1687	1	230kW, 0-300 Amp				Screw, Machine - Round Head
	302-1730	1	250 & 300kW, 0-400 Amp	24	332-0853	1	(#6-32 x 3/4")
			350kW, 0-500 Amp	25	NFS	1	Strip, Marker
	302-1724	1	Dual Scale Volt. Codes L & Z	26	406-0332	2	Plate [301-9855]
	302-1725	1	125kW, 0-250/0-500 Amp	27	871-0015	2	Receptacle, Fastener
	302-1726	1	145 thru 200kW, 0-375/0-750 Amp	28	853-0013	1	Nut, Hex (1/4-20)
	302-1727	1	220 & 230kW, 0-400/0-800 Amp	29	337-0049	1	Washer, Lock - ET (1/4")
	302-1728	1	250 & 275kW, 0-500/0-1000 Amp		800-0024	1	Strap, Electrical (Ground)
	302-1729	1	300 & 310kW, 0-600/0-1200 Amp				Screw, Cap - Hex Head
			350kW, 0-750/0-1500 Amp				(5/16-18 x 1/2")
10	302-1720	1	Meter, Frequency (M23)		856-0008	1	Washer, Lock - ET (5/16")
11		1	Wattmeter (M24) (See	30	508-0051	1	Grommet
			Separate page for Components)	31	402-0527	2	Mount, Vibration
12	NFS	1	Cover, Meter Hole		800-0051	4	Screw, Cap - Hex Head
	815-0385	2	Screw, Machine - Round Head		850-0045	4	(5/16-18 x 1/2")
	870-0183	2	Black (#6-32 x 1/2")				Washer, Lock - Spring
			Nut, Hex with ET Lockwasher	32	NFS	1	(5/16")
			(#6-32)				Box, Control [301-8055]

NFS - Not For Sale

Control Heater (Sets with Housing Enclosure)

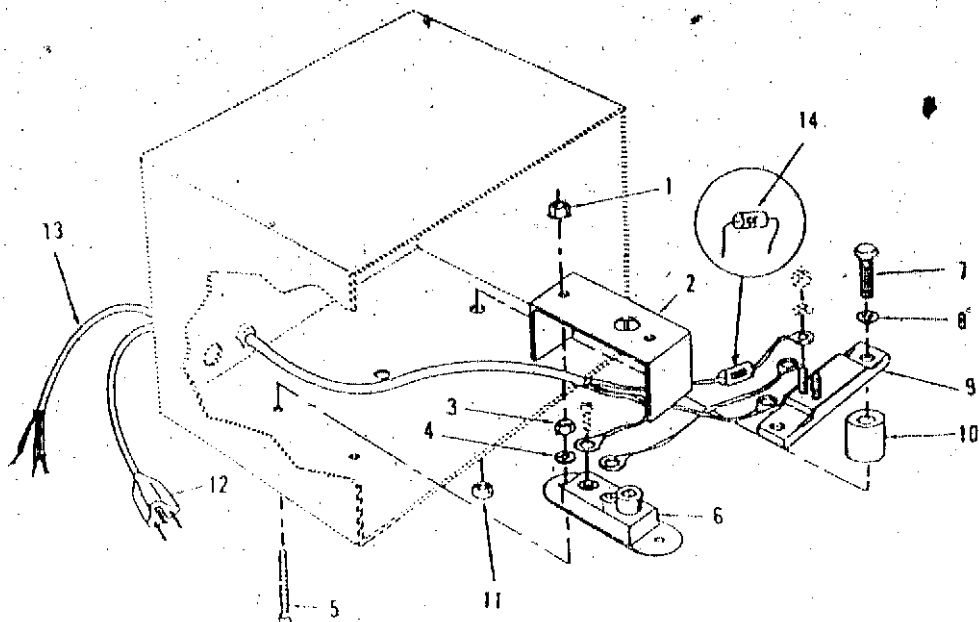

REF NO.	PART NO.	QTY USED	PART DESCRIPTION	REF NO.	PART NO.	QTY USED	PART DESCRIPTION
1	870-0183	2	Nut, Self-locking - Hex (#6-32)	9	333-0151	1	Heater, Electrical 120VAC
2	301-1886	1	Cover		333-0378	1	240VAC
3	860-0006	1	Nut, Hex (#6-32)	10	130-1107	2	Spacer
4	854-0006	2	Washer, Lock - IT (#6)	11	870-0257	2	Nut, Self-locking - Hex (5/16-18)
5	812-0070	2	Screw, Machine - Round Head (#6-32 x 1-1/4")	12	335-0161	1	Cable, Electrical (120VAC Application)
6	309-0128	1	Thermostat, Adjustable	13	338-2121	1	Harness Wiring with Diode, less plug (240VAC Application)
7	800-0034	2	Screw, Cap - Hex Head (5/16-18 x 2-1/4")	14	357-0011	1	Diode
8	525-0113	2	Washer, Flt (5/16")	15	98-3232	1	Decal, Warning - Shock Hazard (Not Illustrated)

Potential Transformer (Sets with Housing Enclosure)

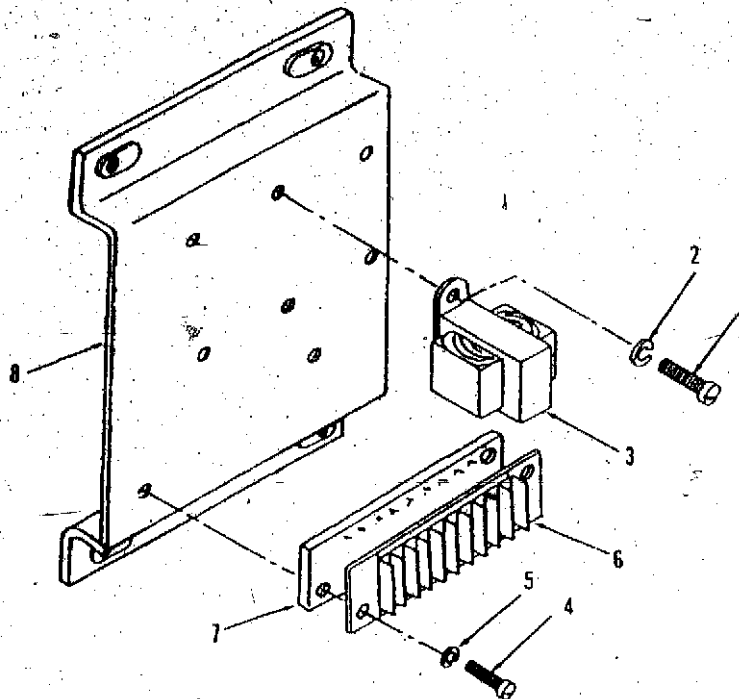

REF NO.	PART NO.	QTY USED	PART DESCRIPTION
1	812-0079	6	Screw, Machine - Round Head (#8-32 x 1/2")
2	850-0025	6	Washer, Lock - Spring (#8)
3	315-0642	3	Transformer, Potential
4	812-0077	2	Screw, Machine - Round Head (#8-32 x 3/8")

REF NO.	PART NO.	QTY USED	PART DESCRIPTION
5	850-0025	2	Washer, Lock - Spring (#8)
6	332-2562	1	Block, Terminal (10 Place)
7	332-2563	1	Strip, Marker
8	NFS	1	Bracket, Mounting

NFS - Not For Sale

Wattmeter (Sets with Housing Enclosure)

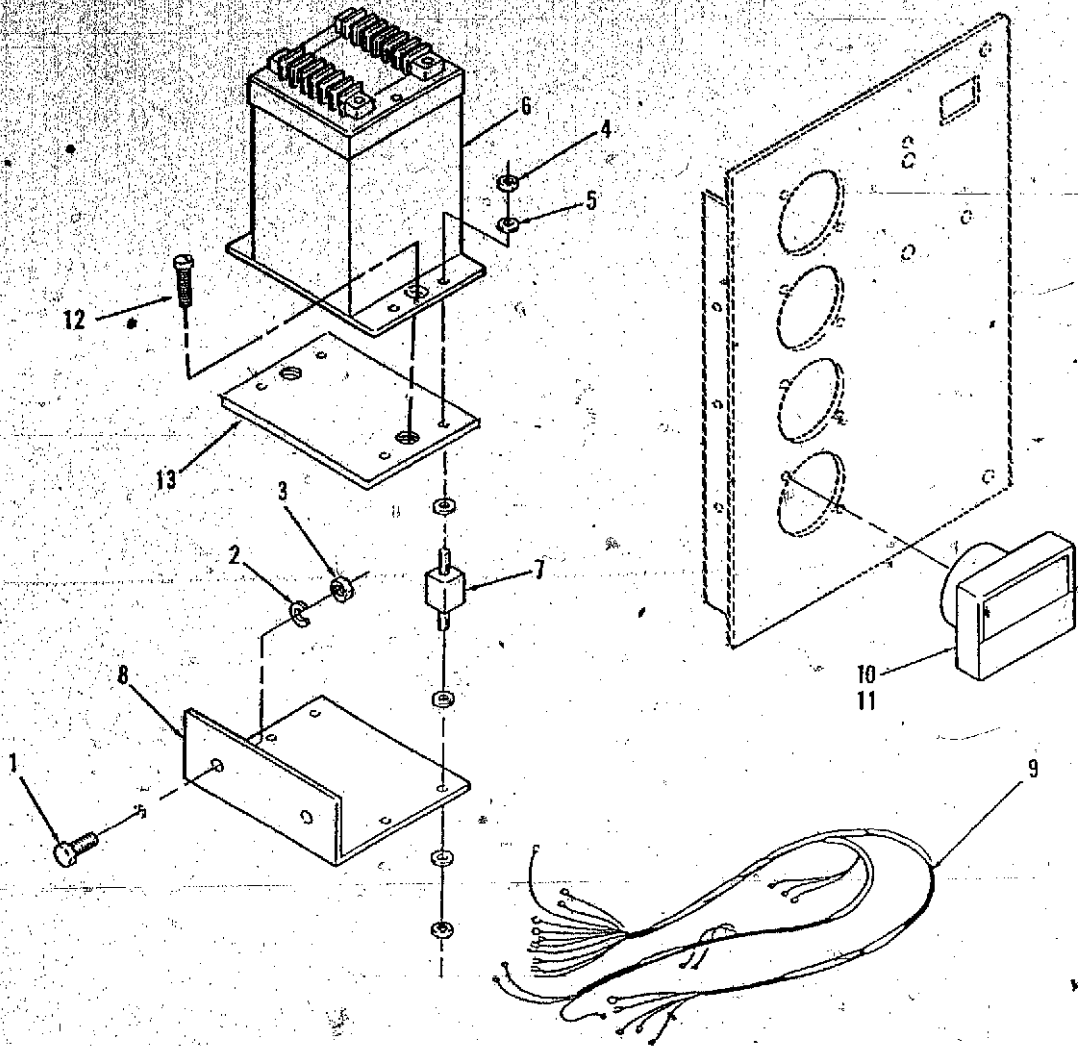

REF NO.	PART NO.	QTY USED	PART DESCRIPTION
1	821-0017	2	Screw, Cap - Hex Head (5/16-18 x 1/2")
2	850-0045	2	Washer, Lock (5/16)
3	862-0014	2	Nut, Hex (5/16-18)
4	860-0008	8	Nut, Hex (#8-32)
5	856-0002	16	Washer, Lock - ET (#8)
6	302-1833-01	1	Transducer, Watt
7	402-0354	4	Mount, Shock
8	301-6987	1	Bracket, Mounting
9	338-1836	1	Harness, Wiring
10	302-1722	1	Wattmeter (Less Dial)

REF NO.	PART NO.	QTY USED	PART DESCRIPTION
11	302-1721-06	1	Dial, Wattmeter
	302-1721-07	1	Scale 0-160 kW
	302-1721-08	1	Scale 0-180 kW
	302-1721-09	1	Scale 0-200 kW
	302-1721-10	1	Scale 0-250 kW
	302-1721-11	1	Scale 0-300 kW
	302-1721-12	1	Scale 0-350 kW
	302-1721-12	1	Scale 0-400 kW
12	813-0102	2	Screw, Machine - Round Head (#10-32 x 3/8")
13	319-0030	1	Plate, Support, Transducer

Redistribution or reproduction of this document by any means, is strictly prohibited.

Generator Set Control (Without Housing Enclosure)

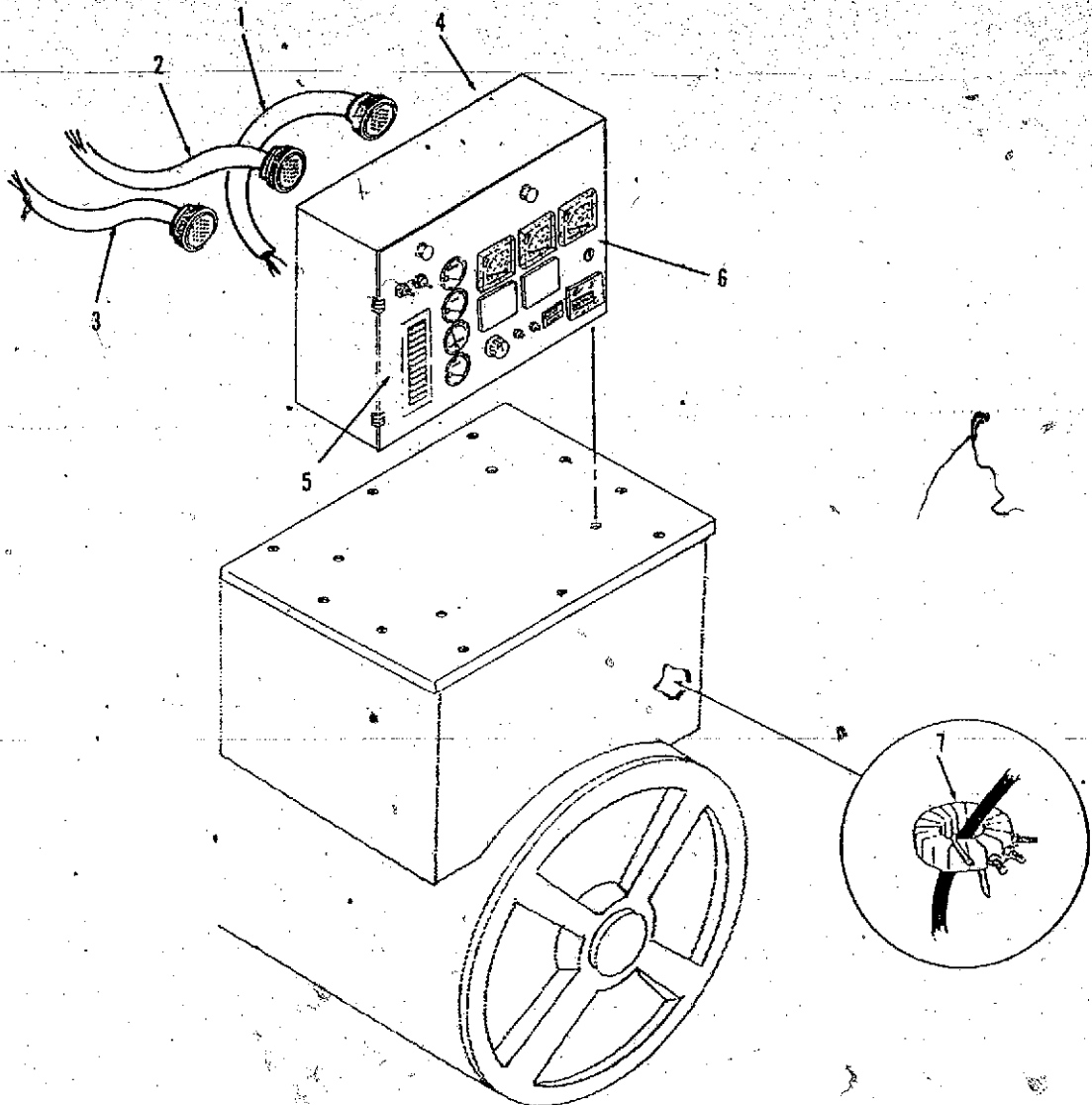

Generator Set Control (Without Housing Enclosure)

REF NO.	PART NO.	QTY USED	PART DESCRIPTION	REF NO.	PART NO.	QTY USED	PART DESCRIPTION
1	338-2201-01	1	Harness, Wiring - Control to Generator (Includes a connector housing)	7			Transformer, Current (Select As Applicable)
	323-1135	1	Housing, Connector (J21)		302-1785-01	3	1200:5 Ratio
	323-1193	4	Contact, Pin		302-1785-02	3	1500:5 Ratio
	323-1194	10	Contact, Pin		302-1785-03	3	1600:5 Ratio
2	338-2195-01	1	Harness, Wiring - Control to Governor (Includes a connector housing)		302-1785-04	3	2000:5 Ratio
	323-1135	1	Housing, Connector (J12)		302-1785-05	3	2500:5 Ratio
	323-1193	4	Contact, Pin		302-1785-06	3	2000:5 Ratio (380v Only)
	323-1194	10	Contact, Pin		302-1785-07	3	3000:5 Ratio
3	338-2190-01	1	Harness, Wiring - Control to Engine Components (Includes a connector housing)		302-1785-08	3	4000:5 Ratio
	323-1206	1	Housing, Connector (J11)		302-1785-09	3	5000:5 Ratio
	323-1194	20	Contact, Pin		302-1786-01	3	500/1000:5 Ratio
4	NFS	1	Control, Set (See item 5 & 6 for Components)		302-1786-02	3	600/1200:5 Ratio
	402-0527	4	Attaching Parts for Control		302-1786-03	3	750/1500:5 Ratio
	800-0051	8	Mount, Vibration		302-1786-04	3	800/1600:5 Ratio
	850-0045	8	Screw, Cap - Hex Head (5/16-18 x 1/2")		302-1786-05	3	900/1800:5 Ratio
			Washer, Lock - Spring (5/16")		302-1786-06	3	1000/2000:5 Ratio
5	NFS	1	Control, Engine (See Separate		302-1786-07	3	1200/2400:5 Ratio
6	NFS	1	Control, Generator (See Separate Page for Components)		302-1786-08	3	250/500:5 Ratio
					302-1786-09	3	300/600:5 Ratio
					302-1786-10	3	400/800:5 Ratio
					302-1786-11	3	375/750:5 Ratio
					302-1786-12	3	75/150:5 Ratio
					302-1786-13	3	100/200:5 Ratio
					302-1786-14	3	150/300:5 Ratio
					302-1786-15	3	200/400:5 Ratio
					302-1786-16	3	1500/3000:5 Ratio

NFS - Not For Sale

Engine Control Components (Sets with Housing Enclosure)

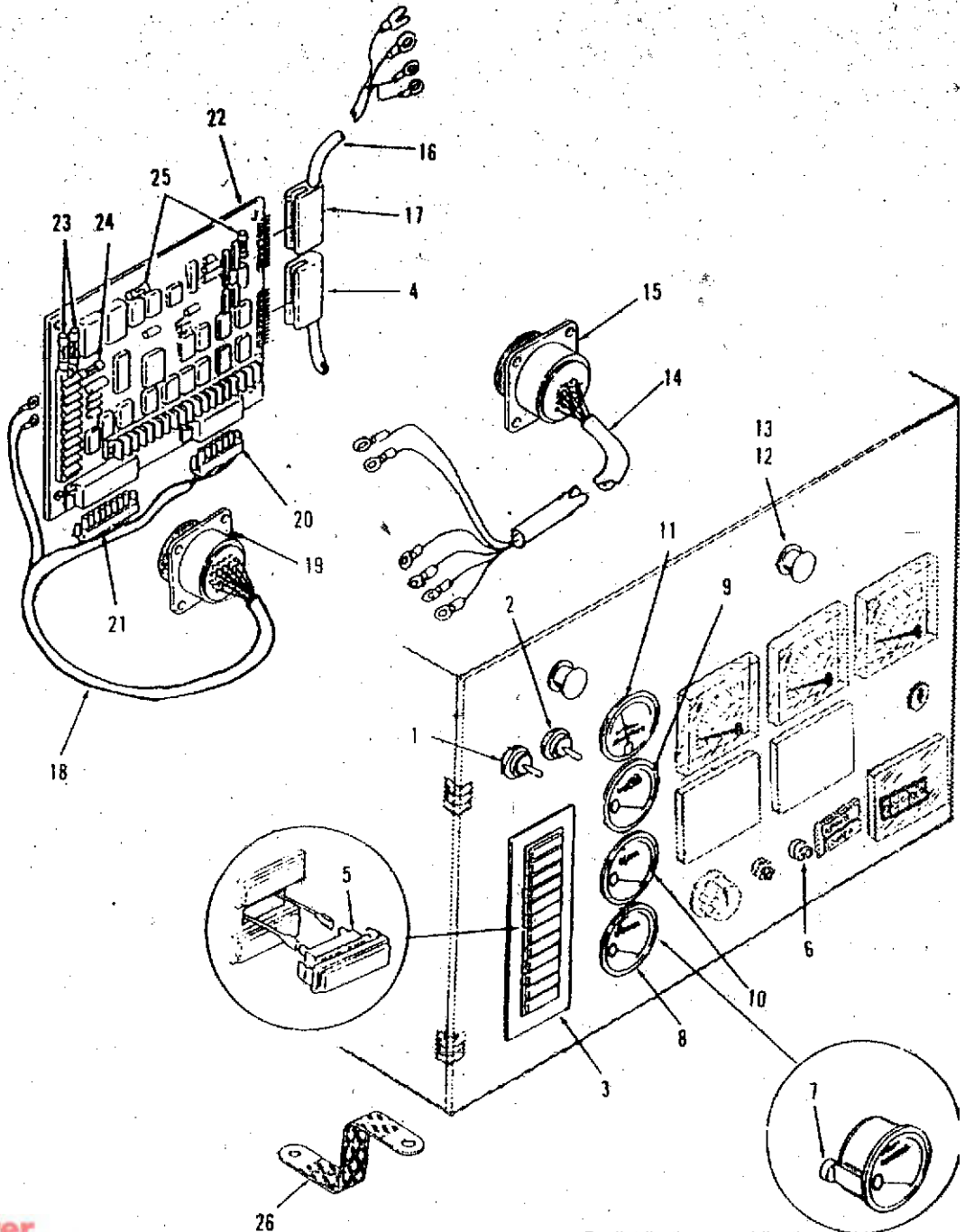

Engine Control Components (Sets with Housing Enclosure)

REF NO.	PART NO.	QTY USED	PART DESCRIPTION	REF NO.	PART NO.	QTY USED	PART DESCRIPTION
1	308-0625	1	Switch, Push (S12) [Run/Stop/Remote]	15	323-1134	1	Housing, Connector (P12)
2	308-0900	1	Switch, Push (S11) [Reset/Panel Light]		323-1192	4	Contact, Socket
3			Module, Indicator - Fault (Includes Harness with a Connector Housing & Contact Pins, Replaceable Lamps) (A12)		323-1195	10	Contact, Socket
	322-0358-02	1	24 VDC, 2 Light		323-1190	2	Key
	322-0360-02	1	24 VDC, 12 Light	16	338-1817	1	Harness, Wiring - Engine - Monitor Board to Meters (Includes Connector Housin
	815-0385	2	Attaching Parts for Module Screw, Machine - Round Head (#6-32 x 1/2")	17	323-1308	1	Housing, Connector (J4)
	870-0183	2	Nut, Self-locking - Hex (#6-32)		323-1302	15	Contact, Pin
4	323-1310	1	Housing, Connector (J3)	18			Harness, Wiring - Engine to Engine Monitor Board (Includes Connector Housin
	323-1302	13	Contact, Pin		338-2244-01	1	Terminals and Contacts)
5	322-0369-02	1	Lamp, Incandescent - 1/3 Watt 28 VDC		338-2422-01	1	Control with 2 Light Mod
6	303-0289	1	Rheostat - Speed Control (R23)	19	323-1207	1	Control with 12 Light Moc
7	193-0250	3	Resistor, Gauge (R11, R12, R15)		323-1195	22	Housing, Connector (P11)
8	193-0330	1	Gauge, Temperature - Oil, 12 VDC (M15) or		323-1190	1	Contact, Socket
	302-1715	1	Tachometer (M16) or	20	323-1304	1	Key
	302-1723	1	Gauge, Blank		323-1200	6	Housing, Connector (J2)
9	193-0351	1	Gauge, Temperature - Water, 12 VDC (M12)	21	323-1306	1	Contact, Pin
10	193-0352	1	Gauge, Pressure - Oil, 12 VDC (M11)	22	323-1200	8	Board, Engine Monitor (A11) (Includes Fuses)
11	302-1790	1	Ammeter (M13)		300-2808	1	24 VDC, 2 Light
12	322-0017	1	Lamp, Incandescent - 28 VDC (DS10, DS11)		300-2812	1	24 VDC, 12 Light
13	322-0361	2	Holder, Lamp	23	321-0270	2	Fuse, Cartridge - 20 Amp (F1, F2)
14			Harness, Wiring - Governor to Speed Control & Tachometer (Includes Connector Housing)	24	321-0231	1	Fuse, Cartridge - 15 Amp (F3)
	338-2245-01	1	Control with 2 Light Module	25	321-0094	2	Fuse, Cartridge - 5 Amp (F4, F5)
	338-2243-01	1	Control with 12 Light Module		815-0544	4	Attaching Parts for Module Screw, Machine - Round Head With IT Lock Washer (#6-32 x 1/2")
				26	337-0049	1	Strap, Electrical - Ground

Generator Control Components (Sets without Housing Enclosure)

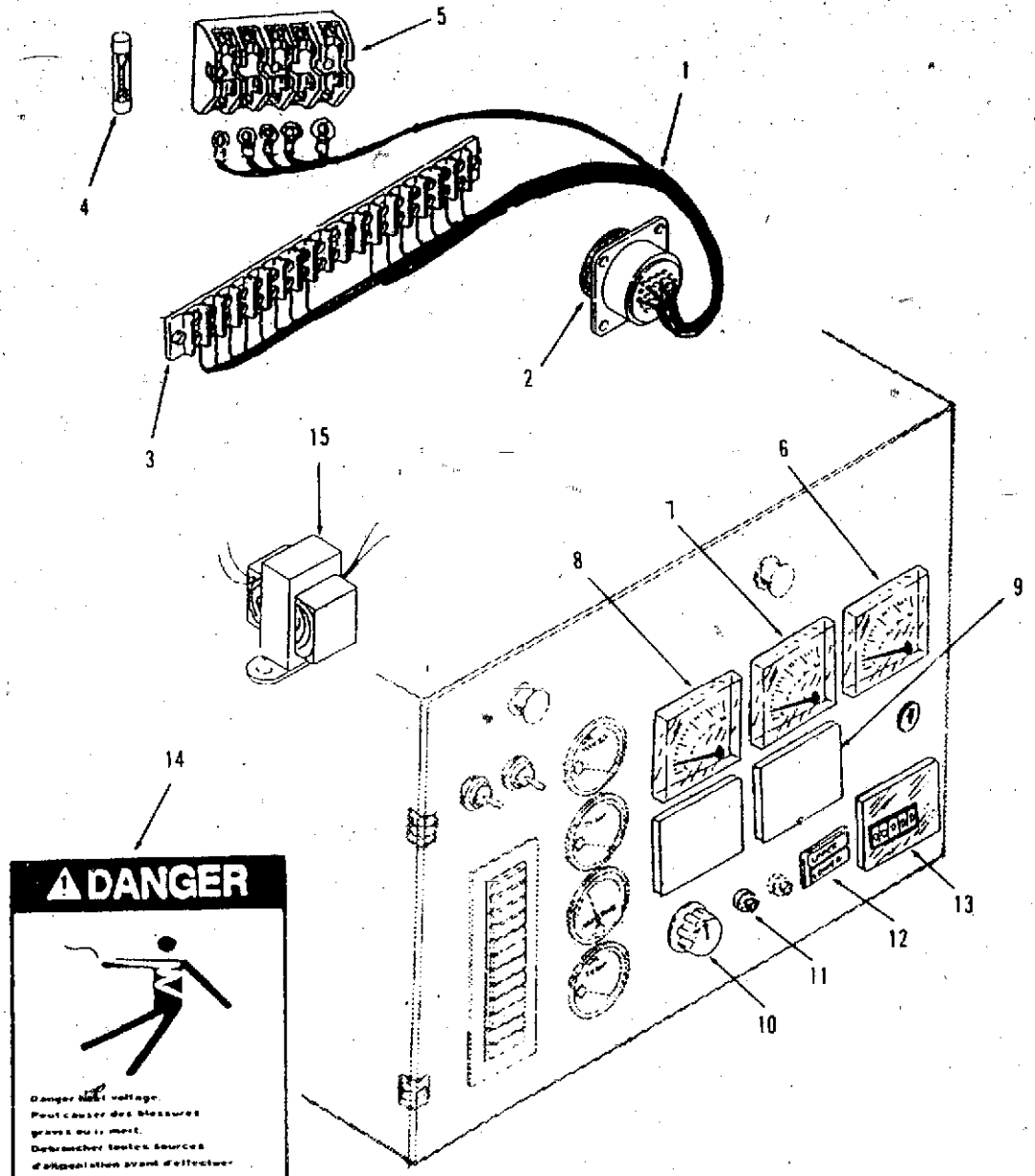

⚠ DANGER

Danger - High Voltage.
 Peut causer des blessures graves ou la mort.
 Débrancher toutes sources d'alimentation avant d'effectuer des réparations.

Hazardous Voltage.
 May cause severe injury or death.
 Disconnect all power supply



Power Generation

Redistribution or publication of this document by any means, is strictly prohibited.

Generator Control Components (Sets with Housing Enclosure)

REF NO.	PART NO.	QTY USED	PART DESCRIPTION	REF NO.	PART NO.	QTY USED	PART DESCRIPTION	
1			Harness, Wiring (Includes Connector and Terminal Strip)	302-1839-09	1	0-300/0-600 Amp		
	338-2240-01	1	Sets with 12 Lead Generator	302-1839-10	1	0-400/0-800 Amp		
	338-2241-01	1	Sets with 6 Lead Generator	302-1839-11	1	0-375/0-750 Amp		
2	323-1134	1	Housing, Connector (P21)	302-1839-12	1	0-75/0-150 Amp		
	323-1192	4	Contact, Socket	302-1839-13	1	0-100/0-200 Amp		
	323-1195	10	Contact, Socket	302-1839-14	1	0-150/0-300 Amp		
	323-1190	1	Key	302-1839-15	1	0-200/0-400 Amp		
3		1	Terminal, Strip (18 Place)	302-1839-16	1	0-1500/0-3000 Amp		
4	321-0293	5	Fuse F1 thru F5	302-1839-17	1	0-2000/0-4000 Amp		
5	321-0294	1	Holder, Fuse	302-1840-01	1	0-1200 Amp		
6	302-1842	1	Meter, Frequency (M23)	302-1840-02	1	0-1500 Amp		
7	302-1841-03	1	Voltmeter (M21)	302-1840-03	1	0-1600 Amp		
8			Ammeter (M22)	302-1840-04	1	0-2000 Amp		
			Dual Scale	302-1840-05	1	0-2500 Amp		
	302-1839-01	1	0-500/0-1000 Amp	302-1840-07	1	0-3000 Amp		
	302-1839-02	1	0-600/0-1200 Amp	302-1840-08	1	0-4000 Amp		
	302-1839-03	1	0-750/0-1500 Amp	302-1840-09	1	0-5000 Amp		
	302-1839-04	1	0-800/0-1600 Amp	9	302-1849	2	Meter, Blank	
	302-1839-05	1	0-900/0-1800 Amp	10	308-0883	1	Switch, Rotary (S21)	
	302-1839-06	1	0-1000/0-2000 Amp	11	303-0287	1	Rheostat (R21)	
	302-1839-07	1	0-1200/0-2400 Amp	12	322-0363	1	Light, Indicator - Dual (OS21, OS22)	
	302-1839-08	1	0-250/0-500 Amp	13	302-1850	1	Meter, Time Totalizing (M14)	
				14	98-5724	2	Decal (Warning)	
				15	315-0664	3	Transformer, Potential (T21 - T23)	

-cont-

-cont-