

2/4A

9540A



**UNITED
TECHNOLOGIES
DIESEL SYSTEMS**

PUMP ROTATION:
Counter Clockwise (as viewed from top)
TIMED FOR PORT CLOSING
SPECIAL FEATURES:

MODEL 50
50-2/4A-80A-9540A

Special information:

Springfield, MA 01107

SERVICE PARTS

Following are all parts, part numbers, pump codes and calibrations for the Model: 50-2/4A-80A-9540A. The exploded view drawing below is detailed with part numbers

listed on the pages indicated. Refer to the Index Section for explanations of codes and abbreviations.

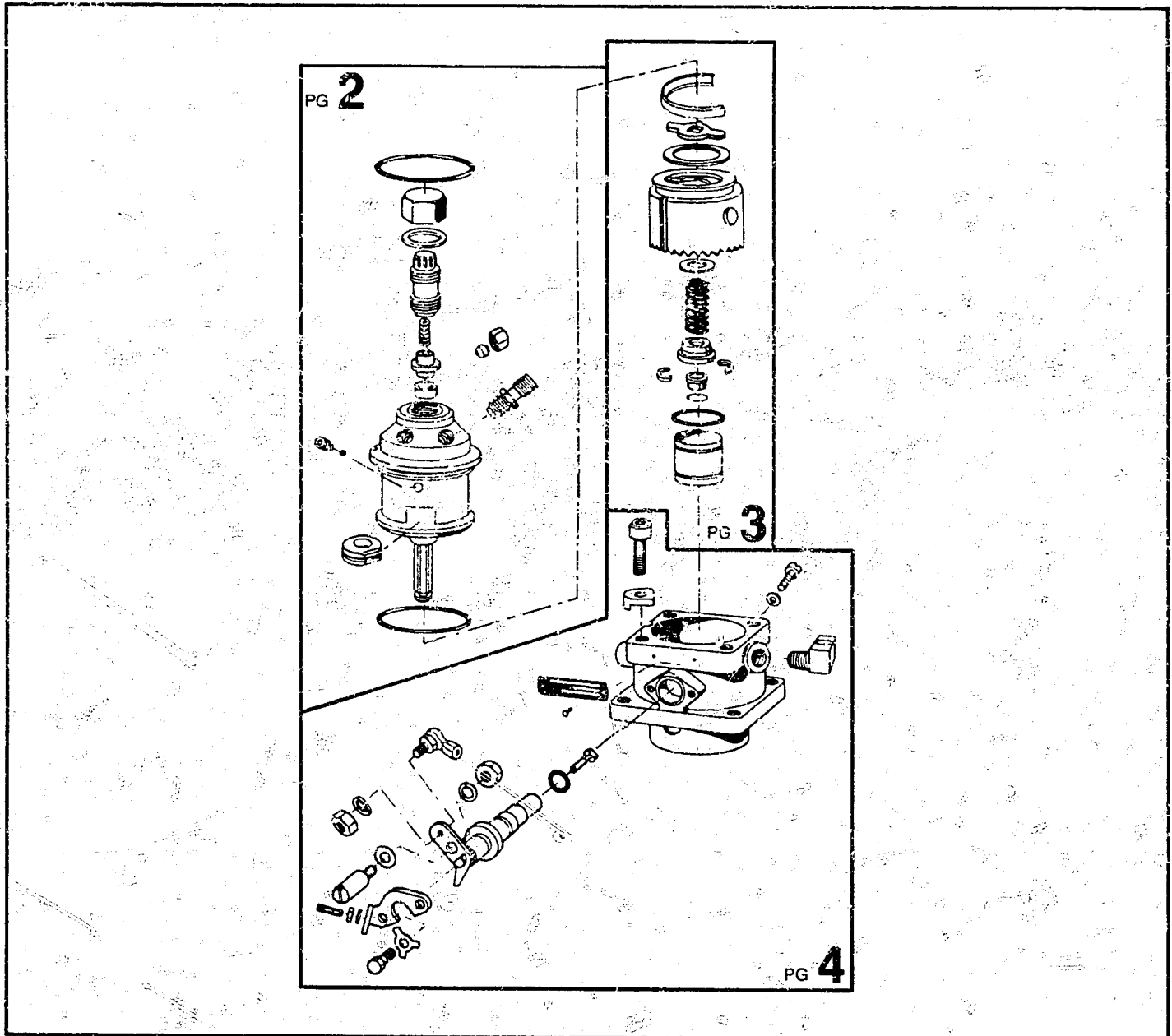

MODEL 50-2/4A-80A-9540A

ASSY HD 9531AS
HYDRAULIC HEAD
ASSY including 1 thru
12, 15 & 16; 1 thru 4, 6 &
9 thru 12 on page 3; and
15 & 19 on page 4

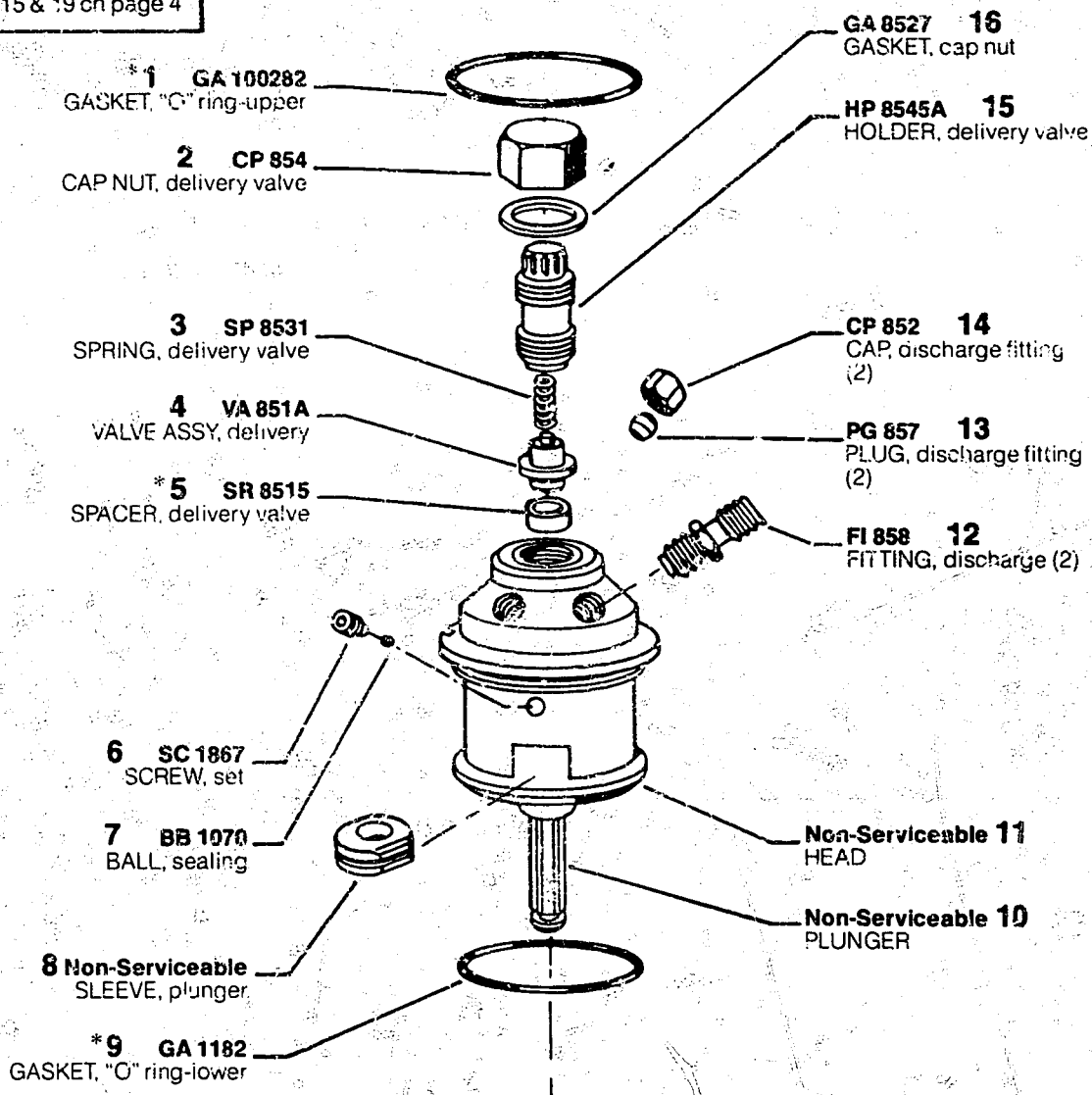

The descriptions are listed as shown in this example:

12	FI 858	FITTING, discharge	(4)
illustration number	part number	description	quantity*

*Quantity used is one, unless otherwise indicated in parenthesis () following description of part.

MODEL 50-2/4A-80A-9540A

*Denotes parts included in Repair Gasket Kit, KT 85236.

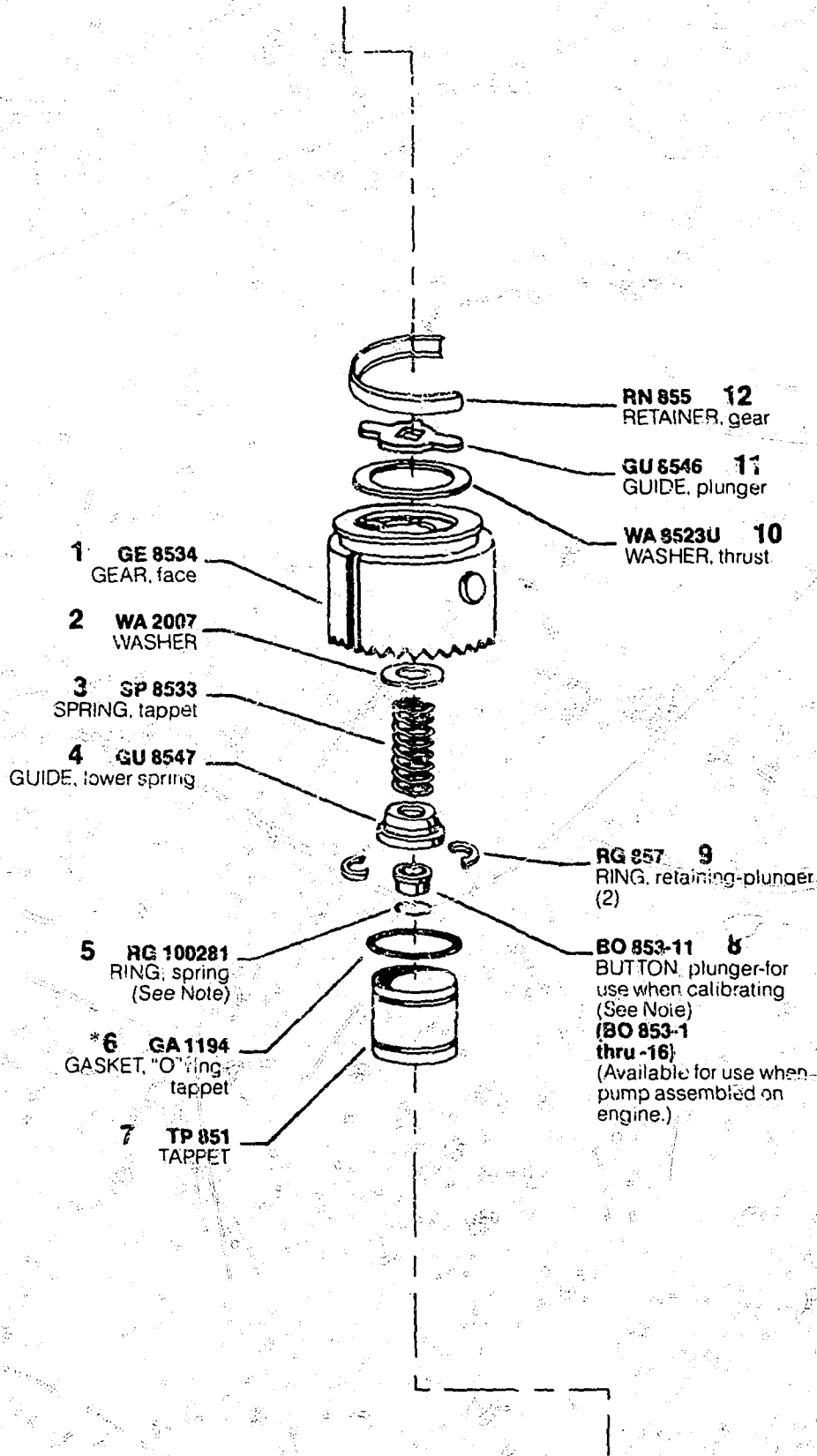

MODEL 50-2/4A-80A-9540A

NOTE: Ring (5) and plunger button (8) are not included with new pump or head assy.

*Denotes parts included in Repair Gasket Kit, KT 85236.

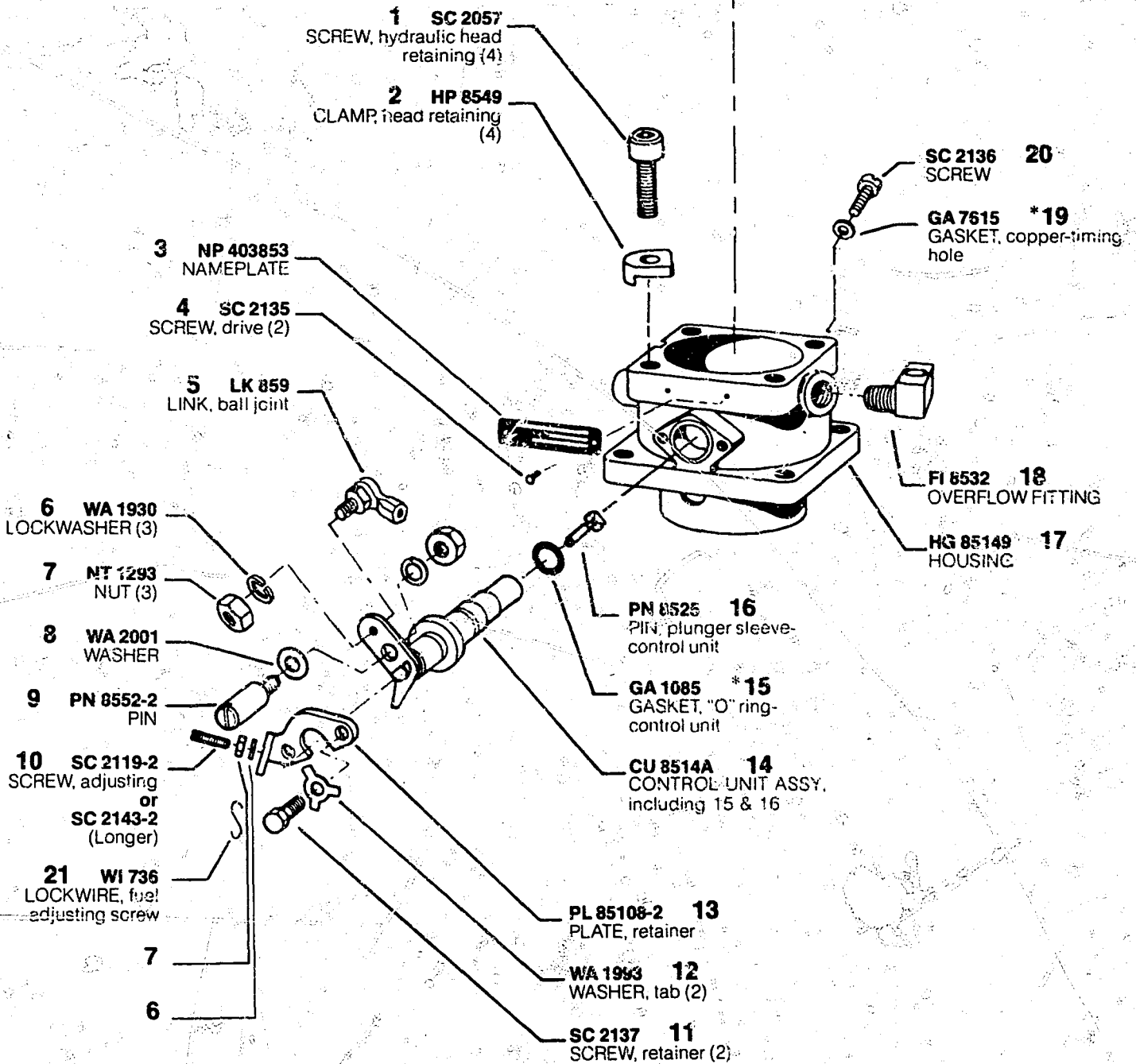

MODEL 50-2/4A-80A-9540A

*Denotes parts included in Repair Gasket Kit, KT 85236.



**UNITED
TECHNOLOGIES
DIESEL SYSTEMS**

CALIBRATION SET-UP

Nozzles & Holders TSE 4500-1000 (AKB 50S 3495B with ACN 12SD 12C)
 Tubing 1/4" O.D. x .084" I.D. x 20' Long (6.35 x 2.13 x 42.7 mm)
 Tubing Nut NT 7935 (pump end)
 Tubing Sleeve (Ermelo) WMJ 2064/1x (calibrating nozzle end)
 Tubing Washer SV 7922 (pump end)
 Calibrating Oil WA 7617 (calibrating nozzle end)
 Lube Oil Viscor 1487 @ 110°-115° F (43°-46° C) supplied at 10-12 psi (.68-.82 bars)
 Test Fixture SAE #20 or #30
 Bacharach #1E7-7033 with evenly spaced, two-lobed cam. #167-0547

PROCEDURE: Refer to Service Instructions and use figures below.

5

**MODEL 50
50-2/4A-80A-9540A**

Springfield, MA 01107

9540A DATA

Engine Model(s) D.O.D., DJE & DJF Customer No. Onan #147-0595

STEP	A	B
	Full Load	Starting Fuel Min Delivery (Check Point)
RPM	900	150
DEL cc/500 str	18.3-19.3	16.5

STEP A: Max variation between cyl: 2.0 cc/500 str

STEP B: Min of 15.0 cc/500 strokes allowable from one cylinder only if min average maintained.